

Established 1850

# PLAINFIELD Township

Value the Past • Embrace the Present • Envision the Future

## PLAINFIELD TOWNSHIP REGULAR MEETING AGENDA

December 13, 2017 - 6:00 P.M.



### Supervisor

**Tony Fremarek**  
815.436.8308 P  
815.436.5117 F

### Trustees

**Ernie Knight**  
**Debbie Kraulidis**  
**Eric Nelson**  
**Matthew Starr**

### Clerk

**Chuck Willard**

### Tax Collector

**Brandon Bernicky**

### Assessor

**Erin C. Kljaich**  
815.436.5110 P  
815.436.5117 F

### Hwy. Commissioner

**Ken Marland**  
815.436.6090 P  
815.436.7050 F

### Address

22525 W. Lockport St.  
Plainfield, IL 60544

### Website

plainfield-township.com

- I. CALL TO ORDER**
- II. PLEDGE/PRAYER**
- III. ROLL CALL FOR QUORUM**
- IV. APPROVAL OF AGENDA**
- V. APPROVAL OF MINUTES**
  - A. Levy Workshop from November 8, 2017
  - B. Regular Township Board Meeting from November 8, 2017
- VI. PUBLIC COMMENTS** (Limited to three minutes per person)
- VII. DONATION REQUESTS**
- VIII. OLD BUSINESS**
- IX. UNFINISHED BUSINESS**
- X. NEW BUSINESS**
  - A. Review 2017 Town Fund Levy Presentation
  - B. Adopt Ordinance #17-08 Town Levy for Fiscal Year 4/1/18 and ending 3/31/19
  - C. Adopt Ordinance #17-09 Road & Bridge Levy for Fiscal Year 4/1/18 and ending 3/31/19
  - D. Approve Annual Pace Contract for 2018
  - E. Approve Resolution #17-05 Resolution of the Plainfield Township Board of Trustees Authorizing the Township Supervisor to Hire and/or Terminate Certain Plainfield Township Employees
  - F. Approve 2018 Cemetery Board Meeting Schedule
  - G. 2018 Health Insurance Renewal Update
  - H. Review and Approve Ad for 2018 PACC Community Directory
- XI. ELECTED OFFICIALS**
  - A. Assessor
  - B. Clerk
  - C. Highway Commissioner
  - D. Tax Collector
  - E. Trustees 1) E. Knight 2) D. Kraulidis 3) E. Nelson 4) M. Starr
  - F. Supervisor
- XII. REPORTS**
  - A. Abilities Team
  - B. Administrator
  - C. Cemetery
  - D. Emergency Coordinator
  - E. Senior Coordinator
  - F. Website/Social Media Development
  - G. Youth Services
- XIII. AUTHORIZATION OF BILLS**
  - A. Town Fund
  - B. Road & Bridge
- XIV. ANNOUNCEMENTS**
  - A. Next Regular Cemetery Board Meeting-January 3, 2018 at 6:00 p.m.
  - B. Next Regular Monthly Board Meeting-January 10, 2018 at 6:00 p.m.
- XV. CLOSED SESSION TO DISCUSS THE FOLLOWING SUBJECTS**
  - A. Personnel: Appointment, employment, compensation, discipline, performance or dismissal of specific Township employees (5 ILCS 5/120/2(c)(1))
- XVI. CLOSED SESSION ACTION ITEMS**
- XVII. ADJOURNMENT**

*Established 1850*

# PLAINFIELD *Township*

Value the Past • Embrace the Present • Envision the Future

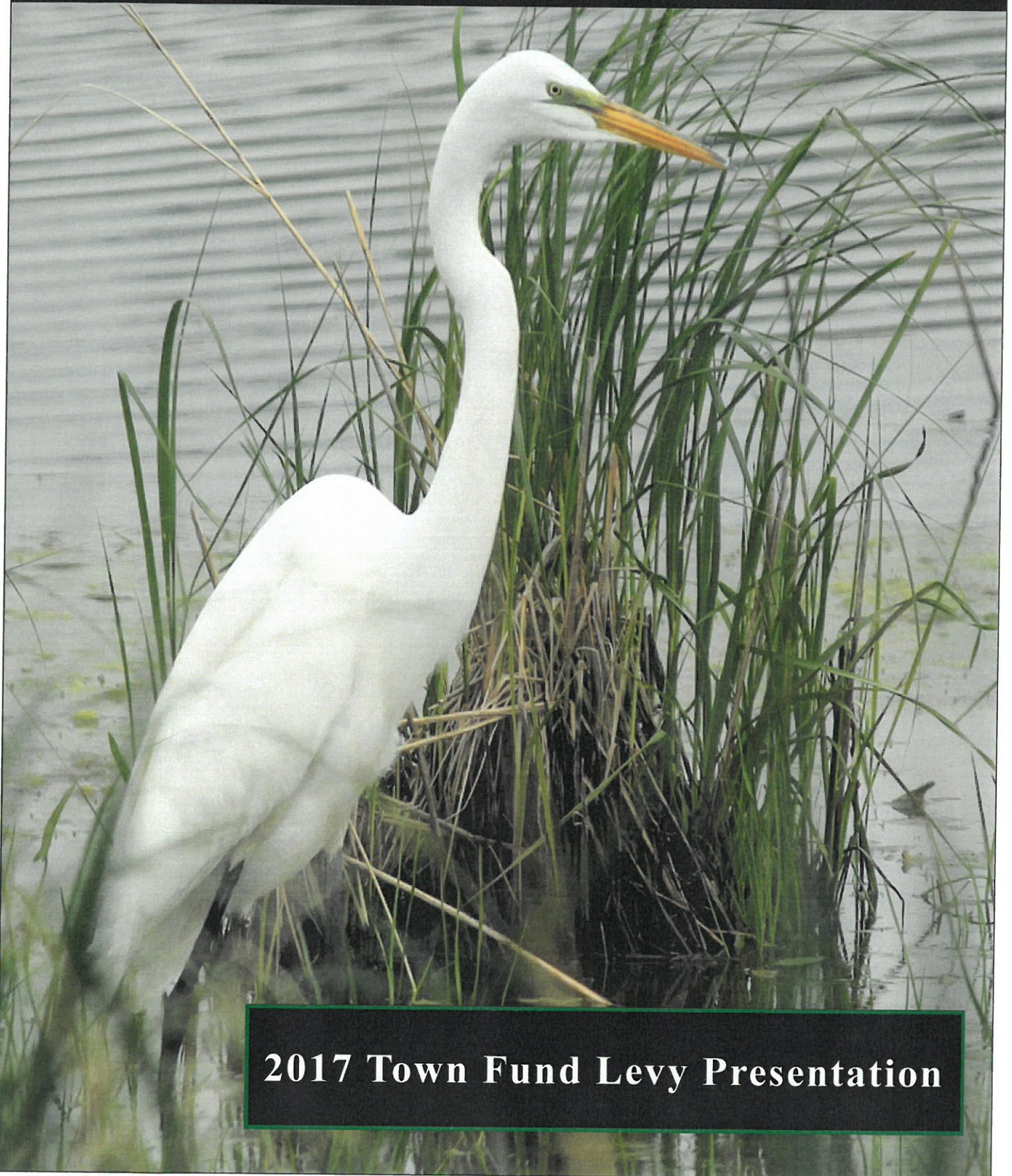

**2017 Town Fund Levy Presentation**



## Table of Contents

<b>Table of Contents</b>	<b>2</b>
<b>Elected Officials and Administrative Staff</b>	<b>3</b>
<b>Township Properties</b>	<b>4</b>
<b>Letter from Administrator</b>	<b>5</b>
<b>Mission Statement</b>	<b>6</b>
<b>History of Townships</b>	<b>7</b>
<b>Plainfield Township History</b>	<b>8</b>
<b>Plainfield Township Services</b>	<b>9</b>
<b>Plainfield Township Boundaries and Location</b>	<b>10</b>
<b>Plainfield Township Demographic Data</b>	<b>11</b>
<b>Revenue Sources</b>	<b>12</b>
<b>PPRT (Personal Property Replacement Tax)</b>	<b>13</b>
<b>PTELL (Property Tax Extension Limitation Law)</b>	<b>14</b>
<b>CPI (Consumer Price Index) History</b>	<b>15</b>
<b>Limiting Rate</b>	<b>16</b>
<b>Town Fund Levy Worksheet</b>	<b>17</b>

## Elected Officials

### *Supervisor*

**Tony Fremarek**

### *Trustees*

**Ernie Knight  
Debbie Kraulidis  
Eric Nelson  
Matthew Starr**

### *Clerk*

**Chuck Willard**

### *Assessor*

**Erin Kljaich**

### *Tax Collector*

**Brandon Bernicky**

### *Highway Commissioner*

**Ken Marland**

---

◆

## Administrative Staff

### *Administrator*

**Andi French**

### *Assistant Administrator*

**Christy Woolley**

### *Office Manager*

**Wendi McKenzie**

### *Assistant Office Manager*

**Lori Gardner**

### *Administrative Assistant*

**Lisa Potocki**

## Township Properties

**Administration Center**  
22525 W. Lockport Street  
Plainfield, IL 60544  
815.436.8308



**Cemetery**  
15408 S. Joliet Road  
Plainfield, IL 60544  
815.436.4350



**Community Center**  
15014 S. DesPlaines Street  
Plainfield, IL 60544  
815.267.3350



Established 1850

# PLAINFIELD Township

Value the Past • Embrace the Present • Envision the Future



**Supervisor**

**Tony Fremarek**  
815.436.8308 P  
815.436.5117 F

**Trustees**

**Ernie Knight**  
**Debbie Kraulidis**  
**Eric Nelson**  
**Matthew Starr**

**Clerk**

**Chuck Willard**

**Tax Collector**

**Brandon Bernicky**

**Assessor**

**Erin Kljaich**  
815.436.5110 P  
815.436.5117 F

**Highway Commissioner**

**Ken Marland**  
815.436.6090 P  
815.436.7050 F

December 13, 2017

**Supervisor Fremarek and Board of Trustees:**

Please review the enclosed Levy Presentation assembled to assist in clarifying key components used to compile the 2017 Town Fund Levy which will fund the 2018-2019 Plainfield Township Budget.

Each board I have worked under for the past 20 years, has done an admirable job of utilizing tax revenues to expand the Township into its current state of facilities, services and partnerships.

Modest improvements continue economically, however; Fiscal Year (FY) 2019 will still be challenging. Since property taxes are the primary source of revenue for the Township, this poses challenges for the Board and staff. One of my ongoing goals is to analyze existing services and day-to-day operations and determine how to enhance, add, or cut wherever necessary. The rising cost of health care and projected capital improvements at each property are important components to consider during the levy process.

Feel free to contact me with any comments or questions.

Sincerely,

**Andi French, Administrator**

## **Motto and Mission Statement**

### **Motto**

Value the Past ● Embrace the Present ● Envision the Future

### **Mission Statement**

With a people-focused approach through efforts from the elected officials and dedicated employees, our mission is to utilize tax dollars in an efficient, effective, and fiscally sound manner to fulfill state mandates, maintain infrastructure, and provide services, information and resources in order to serve and preserve the confidence of the residents and business community.

## History of Townships

As defined in North America:

*noun town-ship \ 'taun-,ship\ - A division of a county with some corporate powers.*

A fully autonomous unit of local government, an Illinois Township is considered a sub-division of the State of Illinois with the authority to tax and issue debt. Townships are not authorized by state statute to impose a sales tax.

In existence for 140 years prior to the signing of the Declaration of Independence, Township government was established in Providence, Rhode Island in 1636. It is the oldest form of government continuing to serve its residents. The wording of the Declaration of Independence reflects the importance of the residents' voices over 200 years ago and continues to hold the same value today during the Annual Town Meeting that is held the second Tuesday of April each year.

*... We hold these Truths to be self-evident, that all Men are created equal, that they are endowed by their Creator with certain unalienable Rights, that among these are Life, Liberty, and the Pursuit of Happiness ~ That to secure these Rights, Governments are instituted among Men, deriving their just Powers from the Consent of the Governed, that whenever any Form of Government becomes destructive of these Ends, it is the Right of the People to alter or to abolish it, and to institute new Government, laying its Foundation on such Principles, and organizing its Powers in such Form, as to them shall seem most likely to effect their Safety and Happiness...*

Residents are also invited to attend the monthly board meetings held every second Wednesday and encouraged to contact the elected officials or staff directly in person, by phone or email with all questions or concerns.



## History of Plainfield Township

Plainfield Township was established on November 6, 1849 under Supervisor Leander Hamlin. The First Annual Town Meeting was held April 2, 1850.

Land was divided similar to a checkboard into six mile squares called Survey Townships; each Township is roughly 36 square miles. The majority of Illinois Townships are survey type with a few exceptions where a county border or body of water are used to form the physical border.

According to U.S. Census Bureau statistics, the following 20 states still operate under some type of organized township government:

Connecticut, Illinois, Indiana, Kansas, Maine, Massachusetts, Michigan,  
Minnesota, Missouri, Nebraska, New Hampshire, New Jersey, New York,  
North Dakota, Ohio, Pennsylvania, Rhode Island, South Dakota,  
Vermont and Wisconsin.

Mandated by law, townships must perform three functions: administer a General Assistance program to qualifying residents, maintain township road district highways and bridges, and appraise property values.

## Plainfield Township Services

A wide variety of additional services are offered at the Administration Building, Community Center and Cemetery with the continued goal of enhancing those services as well as expanding services whenever possible.

- Abilities Team
- Bee Hives and Informational Seminars (*Partnership with 4-H*)
- Brush Pickup
- Community Garden Plots
- Dial-A-Ride (PACE Bus)
- Emergency Management Coordinator
- Eyeglass Collection (*Partnership with the Plainfield Lion's Club*)
- Food Pantry Facility (*Partnership with Plainfield Interfaith Food Pantry*)
- General and Emergency Assistance
- Ladder Up (*Partnership with TAP—Tax Assistance Program*)
- Leaf Pickup
- LIHEAP (*Partnership with WCCCC—Will County Center for Community Concerns*)
- Marriage Licenses (*Partnership with Will County Clerk*)
- Medical Loan Closet
- Meeting Room Rentals
- Monarch Butterfly Way Station
- Mosquito Abatement
- Nicor Sharing Assistance (*Partnership with Nicor via Salvation Army*)
- Notary
- Passport Processing and Photo Service (*Partnership with Chicago Passport Agency*)
- Salvation Army Assistance (*Partnership with Salvation Army*)
- Senior Christmas Luncheon (*Partnership with Plainfield Township Park District*)
- Senior Services Center of Will County Satellite Location at PTCC (*Partnership with SSCWC*)
- Senior Services Coordinator (*Partnership with Plainfield Township Park District*)
- Senior Shuttle Buses
- Senior Summer Picnic (*Partnership with Plainfield Township Park District*)
- Snow Removal
- Street Maintenance
- Taxi 1/2 Fare Program (*Pending*)
- Toys for Tots (*Partnership with the U.S. Marine Corps*)
- Voter Registrar (*Partnership with Will County Clerk*)
- Weed Control
- Youth Committee
- Youth Scholarships for High School Seniors

Future services I am researching include, but aren't limited to, Job Resource Center, Mobile Dental Clinic, Mobile Driver's License Services, Newsletter via Email/Website, Shredding Event, SNAP Satellite Location, and Temporary Disabled Parking Placards.

## Boundaries/Location

Plainfield Township boundaries are 135th Street to the North; County Line Road to the West; Theodore Road to the South and Gaylord Road to the East.

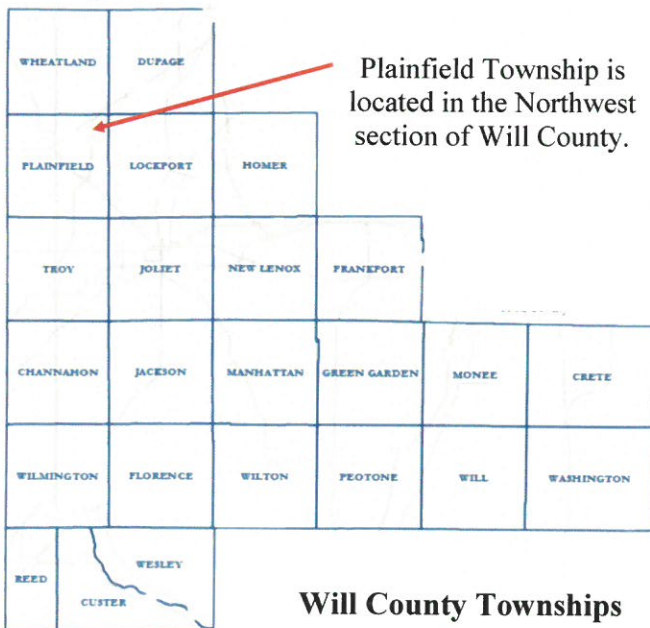
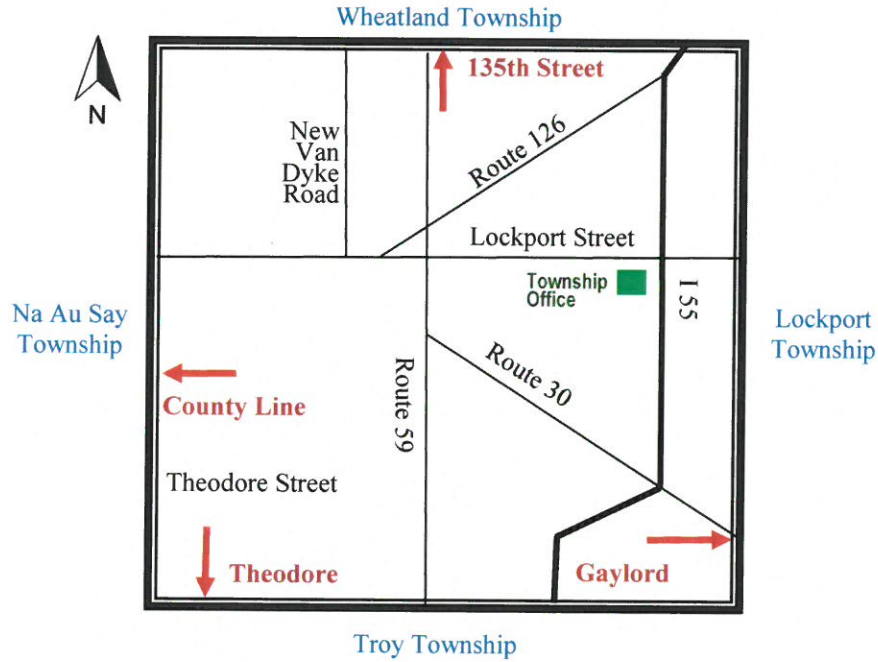

Plainfield Township is located in the Northwest section of Will County.



## Demographic Data

### Households by Municipality

*(Including vacant lots)*

	<u>2016 Report</u>	<u>2017 Report</u>
City of Crest Hill	225	225
City of Joliet	12,288	12,619
Village of Plainfield	7,038	7,633
Village of Romeoville	2,616	2,650
Unincorporated	<u>4,992</u>	<u>5,058</u>
<b>Total</b>	<b><u>27,159</u></b>	<b><u>28,185</u></b>

### Parcels

	<u>2016 Report</u>	<u>2017 Report</u>
Residential	27,520	28,674
Commercial	907	1,138
Industrial	70	135
Farm and other	219	311
Exempt	<u>361</u>	<u>384</u>
<b>Total</b>	<b><u>29,077</u></b>	<b><u>30,642</u></b>

## Revenue Sources

The majority of monies Plainfield Township uses to operate are derived from general property taxes. The remaining funds are a culmination of property replacement taxes, grants, fines, fees, and interest income.

**Property Taxes** - The Township levies for property taxes for the General Town Fund which also funds the budgets for the Assessor and Cemetery. The amount of funds received in general property taxes is limited by the Property Tax Extension Limitation Law (aka PTELL). Illinois Statute 35 ILCS 200/18-185 PTELL limits the increase in property tax the Township may levy to 5% over the prior year's extension or the increase in the Consumer Price Index (CPI) during the 12 calendar months for the year preceding the levy year; whichever is less.

Will County typically distributes property taxes once a month in May, June, July, August, September, October, and December; twice in November.

**Property Replacement Taxes (PPRT)** - Both the General Town Fund and Road and Bridge Fund receive revenue collected by the State of Illinois to replace money that was lost by local governments when their powers to impose personal property taxes on corporations, partnerships, and other business entities were taken away. PPRT payments are directly deposited into the money market accounts in January, March, April, May, July, August, October and December. (Page 13 gives detailed information.)

**Miscellaneous Revenue** - The balance of monies received into the General Town Fund are comprised of grants, shuttle bus fees, meeting room rental fees, passport fees, passport photo fees, and interest income. The balance of monies received into the Road and Bridge Fund come from traffic fines, easement fees, and interest income.

## Personal Property Replacement Tax (PPRT)

**What are replacement taxes?** - Replacement taxes are revenues collected by the state of Illinois and paid to local governments to replace money that was lost by local governments when their powers to impose personal property taxes on corporations, partnerships, and other business entities were taken away. These taxes resulted when the new Illinois Constitution directed the legislature to abolish business personal property taxes and replace the revenue lost by local government units and school districts. In 1979, a law was enacted to provide for statewide taxes to replace the monies lost to local governments.

**Who pays these taxes?** - Corporations, partnerships, trusts, S corporations and public utilities.

**What are the rates?** - (1) Corporations pay a 2.5 percent tax on income. (2) Partnerships, trusts, and S corporations pay a 1.5 percent tax on income. (3) Public utilities pay a 0.8 percent tax on invested capital.

**How is the money distributed?** - The proceeds from these taxes are placed into the Personal Property Replacement Tax Fund to be distributed to local taxing districts. The total collections are divided into two portions. One portion (51.65 percent) goes to Cook County. The other portion (48.35 percent) goes to downstate counties. The Cook County portion is then distributed to the taxing districts in Cook County on the basis of each district's share of personal property tax collections for the 1976 year. (For example, if total taxes collected by all districts were \$1 million and District A collected \$35,000 of that total, District A's share of any future distributions would be 3.5 percent.) The downstate portion is distributed similarly, except that the collections from the 1977 tax year are used to calculate each district's share of the distribution. This percentage is called the district's "allocation factor."

**Can a district's allocation factor change?** - Yes. Local taxing districts can continue to collect unpaid personal property taxes owed for the base year (1976 for Cook County; 1977 for downstate counties) and increase their share of the distribution. On the other hand, an allocation factor can decrease due to tax refunds made for the base year. The allocation factor can be adjusted for each payment if there are significant shifts in collections for the base year for that district or other districts sharing the same portion of the fund.

**Who qualifies to receive these payments?** - Only districts that collected personal property taxes for the 1977 tax year, 1976 for Cook County, are eligible to receive a share of the money. Districts created after 1977 do not receive replacement tax money since they did not experience a loss in revenue.

**Are there restrictions on how replacement tax money can be used?** - Certain municipalities and townships also are required to allocate a portion of their payments to dependent library districts under their jurisdictions. After these obligations have been satisfied, the remaining money can be used for the same purposes as the money the district raised through real estate taxes.

## Property Tax Extension Limitation Law (PTELL)

When calculating the levy, both the General Town Fund and the Road and Bridge Fund are subject to PTELL as explained below by the Illinois Department of Revenue.



Illinois Department of Revenue

### An Overview of the Property Tax Extension Limitation Law by Referendum

---

#### What is the Property Tax Extension Limitation Law (PTELL)?

The PTELL is designed to limit the increases in property tax extensions (total taxes billed) for non-home rule taxing districts.

Although the law is commonly referred to as "tax caps," use of this phrase can be misleading. The PTELL does not "cap" either individual property tax bills or individual property assessments. Instead, the PTELL allows a taxing district to receive a limited inflationary increase in tax extensions on existing property, plus an additional amount for new construction.

The limit slows the growth of revenues to taxing districts when property values and assessments are increasing faster than the rate of inflation. As a whole, property owners have some protection from tax bills that increase only because the market value of their property is rising rapidly.

Payments for bonds issued without voter approval are subject to strict limitations.

If a taxing district determines that it needs more money than is allowed by the limitation, it can ask the voters to approve an increase.

The collar counties (DuPage, Kane, Lake, McHenry, and Will) became subject to the PTELL for the 1991 levy year for taxes paid in 1992; Cook County was added for the 1994 levy year for taxes paid in 1995. Public Act 89-510 allows county boards to give voters in all other counties the opportunity to decide if the PTELL should apply to their counties. In addition, Public Act 89-718 allows county boards of counties that are subject to the PTELL by referendum to give voters the opportunity to rescind the PTELL using the same referendum process.

Public Act 94-976 amended PTELL effective June 30, 2006. The significant amendments include:

- New supplemental ballot and election notice information.
- Additional taxing district voter-approved referenda and other referenda changes.
- Authority for taxing districts in some instances to exceed a voter-approved rate limit for a fund as long as the sum of all the rates for funds subject to PTELL, does not exceed the limiting rate.

#### What is the "limitation"?

Increases in property tax extensions are limited to the lesser of 5% or the increase in the national Consumer Price Index (CPI) for the year preceding the levy year. The limitation can be increased for a taxing body with voter approval.

The CPI used is for all urban consumers for all items as published by the United States Department of Labor. A CPI history of the limitation is available on our website at [tax.illinois.gov/LocalGovernment/PropertyTax/CPIhistory](http://tax.illinois.gov/LocalGovernment/PropertyTax/CPIhistory).



## Consumer Price Index (CPI) History

Illinois Dept. of Revenue  
History of CPI's Used for the PTELL  
1/18/2017

Year	December CPI-U	% Change From Previous December	% Use for PTELL	Comments	Levy Year	Years Taxes Paid
1991	137.900	--				
1992	141.900	2.9%	2.9%		1993	1994
1993	145.800	2.7%	2.7%	(5 % for Cook)	1994	1995
1994	149.700	2.7%	2.7%		1995	1996
1995	153.500	2.5%	2.5%		1996	1997
1996	158.960	3.6%	3.6%		1997	1998
1997	161.300	1.5%	1.5%		1998	1999
1998	163.900	1.6%	1.6%		1999	2000
1999	168.300	2.7%	2.7%		2000	2001
2000	174.000	3.4%	3.4%		2001	2002
2001	176.700	1.6%	1.6%		2002	2003
2002	180.900	2.4%	2.4%		2003	2004
2003	184.300	1.9%	1.9%		2004	2005
2004	190.300	3.3%	3.3%		2005	2006
2005	196.800	3.4%	3.4%		2006	2007
2006	201.800	2.5%	2.5%		2007	2008
2007	210.036	4.08%	4.1%		2008	2009
2008	210.228	0.1%	0.1%		2009	2010
2009	215.949	2.7%	2.7%		2010	2011
2010	219.179	1.5%	1.5%		2011	2012
2011	225.672	3.0%	3.0%		2012	2013
2012	229.601	1.7%	1.7%		2013	2014
2013	233.049	1.5%	1.5%		2014	2015
2014	234.812	0.8%	0.8%		2015	2016
2015	236.525	0.7%	0.7%		2016	2017
2016	241.432	2.1%	2.1%		2017	2018

## Calculating the Limiting Rate

The levy is the process of calculating the funds from general real estate taxes you need to fund the budget for the year ahead.

How much can be levied is restricted by the CAP Rate—the absolute maximum rate you can have and PTELL—Property Tax Extension Limitation Law (See page 14) which limited the increase in property tax that the Township may levy to 5% over the prior year’s extension or the increase in the CPI (Consumer Price Index ) during the 12 calendar months for the year preceding the levy year (a.k.a. Limiting Rate), whichever is less.

FORMULA:					
Extension Base	X	CPI	=	Adjusted Extension Base	Limiting Rate
EAV	-	New Property	=	Adjusted Valuation Base	

Calculating the Limiting Rate: Calculate by multiplying the aggregate extension base, by the extension limitation (CPI), by any rate increase factor. Then divide that answer by the sum of NET EAV minus New Property, minus annexations, plus disconnections. This quotient is the Limiting Rate.

Proposed Town Fund LR:

CALCULATIONS					
1,499,848.10	X	1.0210	=	1,531,344.91	= 0.0838
1,844,745,024	-	16,679,841	=	1,828,065,183	

## Town Fund 2017 Levy Calculations

Taxing District: Plainfield Township 242

<b>Gross AV *</b>	2,021,090,666	
<b>PRIOR YEAR EXEMPTIONS/TIF **</b>	176,345,642	<b>NEW PROPERTY ***</b>
<b>E.A.V.</b>	<b>1,844,745,024</b>	16,679,841

AGGREGATE EXTENSION	2014	2015	2016
<b>3 YEAR BASE HISTORY</b>	1,455,094.55	1,476,764.37	<b>1,499,848.10</b>
Extension Base utilized is the highest Aggregate Extension of the last 3 years			

**FORMULA:**

Extension Base	X	CPI	=	Adjusted Extension Base	=	Limiting
EAV	-	New Property	=	Adjusted Valuation Base	=	Rate

**CALCULATIONS**

1,499,848.10	X	1.0210	=	1,531,344.91	=	
1,844,745.024	-	16,679,841	=	1,828,065,183	=	<b>0.0838</b>

<b>Extension Limit</b>	<b>1,545,317.38</b>	<b>(EAV X Estimated Limiting Rate)</b>
Difference from last year	45,469.28	(Extension Limit - Prior Year Extension)
<b>Truth in Taxation Limit</b>	<b>1,574,690.52</b>	<b>(Prior Year Extension X 4.99% Increase)</b>

\* The numbers used in this worksheet are estimates and are subject to change at any time. Final EAV is calculated in March, and used for final calculation of the May 1st bills. This worksheet is to be used as a reference only and makes no warranties as to the final results.

\*\* This figure should be estimated using the total amount of value lost to exemptions in the prior year plus the total amount of value lost to TIF Districts in the prior year. If the district was affected in the prior year by a TIF that has now expired, do not subtract that TIF's Incremental Value from this calculation. The Incremental TIF Value will instead be manually added to the estimated New Property figure.



**TOWN TAX LEVY ORDINANCE**  
**ORDINANCE NO. 17-08**

AN ORDINANCE levying taxes for all town purposes for Plainfield Township, Will County, Illinois, for the tax year 2017, collectable in 2018.

BE IT ORDANINED by the Board of Trustees of Plainfield Township, Will County, Illinois, as follows:

SECTION 1: That the sum of **one million, five hundred seventy-four thousand, six hundred ninety-one** (\$1,574,691) is hereby levied upon all property subject to taxation within the Township as that property is assessed and equalized, in order to meet and defray all the necessary expenses and liabilities of the township as required by statute or voted by the people in accordance with the law, for such purposes as: **Town Fund** for the year 2018.

SECTION 2: That the amount levied for each object and purpose shall be as follows:

<u>GENERAL TOWN FUND</u>	<u>Amount Levied</u>
<b>Administration</b>	
Personnel	\$545,000
Contractual Services	\$340,691
Commodities	\$ 18,000
Capital Outlay	\$152,000
Other Expenditures	\$ 89,000
Contingency Reserve	\$ 10,000
<b>Total Administration:</b>	<b>\$1,154,691</b>
<b>Assessor</b>	
Personnel	\$237,000
Contractual Services	\$ 60,500
Commodities	\$ 2,000
Capital Outlay	\$ 10,000
Other Expenditures	\$ 500
<b>Total Assessor:</b>	<b>\$ 310,000</b>
<b>Cemetery</b>	
Personnel	\$ 60,000
Contractual Services	\$ 20,000
Commodities	\$ 5,500
Capital Outlay	\$ 24,000
Other Expenditures	\$ 500
<b>Total Administration:</b>	<b>\$ 110,000</b>
<b>TOTAL GENERAL TOWN FUND:</b>	<b>\$1,574,691</b>



SECTION 3: That the Town Clerk shall make and file with the County Clerk of said County of Will, on or before the last Tuesday of December, a duly certified copy of this ordinance.

SECTION 4: That if any section, subdivision, or sentence of this resolution shall for any reason be held invalid or to be unconstitutional, such finding shall not affect the validity of the remaining portion of this ordinance.

SECTION 5: That this ordinance shall be in full force and effect after its adoption, as provided by law.

ADOPTED this 13<sup>th</sup> day of December 2017, pursuant to a roll call vote by the Board of Trustees of Plainfield Township, Will County, Illinois.

<b><u>BOARD OF TRUSTEES</u></b>	<b><u>AYE</u></b>	<b><u>NAY</u></b>	<b><u>ABSENT</u></b>
Ernie Knight	_____	_____	_____
Debbie Kraulidis	_____	_____	_____
Eric Nelson	_____	_____	_____
Matthew C. Starr	_____	_____	_____
Anthony F. Fremarek	_____	_____	_____

---

Anthony F. Fremarek, *Supervisor*

---

Charles H. Willard, *Clerk*



## ROAD & BRIDGE TAX LEVY ORDINANCE

### ORDINANCE NO. 17-09

AN ORDINANCE levying taxes for all road and bridge purposes for Plainfield Township Road District, Will County, Illinois, for the tax year 2017, collectable in 2018.

BE IT ORDAINED by the Board of Trustees of Plainfield Township, Will County, Illinois, as follows:

SECTION 1: That the Highway Commissioner of Plainfield Township Road District on December 13, 2017, does hereby determine and declare that the sum of **Two Million Eighty-Seven Thousand, Nine Hundred Thirty-Seven, (\$2,087,937)** is hereby levied upon all property subject to taxation within the Road District as that property is assessed and equalized, in order to meet and defray all the necessary expenses and liabilities of the Road District as required by statute or voted by the people in accordance with the law, for such purposes as:

**Road and Bridge (General Road) for the year 2017.**

SECTION 2: That the amount levied for each object and purpose shall be as follows:

<b><u>GENERAL ROAD FUND</u></b>	<b><u>Amount</u></b>	
<b><u>Administration</u></b>	<b><u>Levied</u></b>	
Personnel	\$ 55,000	
Contractual Services	\$ 90,000	
Commodities	\$ 2,000	
Capital Outlay	\$ 2,000	
Other Expenditures	\$ 5,000	
<b>Total Administration:</b>		<b>\$ 154,000</b>
<b>Maintenance</b>		
Personnel	\$450,000	
Contractual Services	\$406,564	
Commodities	\$100,000	
Capital Outlay	\$ 50,000	
Contingencies	\$ 40,000	
Taxes Paid to the Following Municipalities: (Bolingbrook, Crest Hill, Joliet, Plainfield, Romeoville)	\$887,373	
<b>Total Maintenance</b>		<b>\$1,933,937</b>
<b>TOTAL GENERAL ROAD FUND:</b>		<b>\$2,087,937</b>

REF: General Road & Bridge Tax (605 ILCS 5/6-501 & 5/6-504)

**TAX LEVY SUMMARY**

Road & Bridge Tax

\$2,087,937

**TOTAL TAXES LEVIED:**

**\$2,087,937**

Amount to be Levied was determined by the Highway Commissioner of Plainfield Township Road District.

  
Kenneth Marland, Highway Commissioner

SECTION 3: That the Town Clerk shall file with the Will County Clerk, on or before the last Tuesday of December, a duly certified copy of this ordinance.

SECTION 4: That the Board of Trustees does hereby certify that the amount levied herein is necessary to be raised by taxation for road purposes for Plainfield Township Road District.

SECTION 5: That if any section, subdivision, or sentence of this ordinance shall for any reason be held invalid or to be unconstitutional, such finding shall not effect the validity of the remaining portion of this ordinance.

SECTION 6: That this ordinance shall be in full force and effect after its adoption, as provided by law.

ADOPTED this 13<sup>th</sup> day of December 2017, pursuant to a roll call vote by the Board of Trustees of Plainfield Township, Will County, Illinois.

**BOARD OF TRUSTEES**

**AYE**

**NAY**

**ABSENT**

Ernie Knight

\_\_\_\_\_

\_\_\_\_\_

\_\_\_\_\_

Debbie Kraulidis

\_\_\_\_\_

\_\_\_\_\_

\_\_\_\_\_

Eric Nelson

\_\_\_\_\_

\_\_\_\_\_

\_\_\_\_\_

Matthew C. Starr

\_\_\_\_\_

\_\_\_\_\_

\_\_\_\_\_

Anthony F. Fremarek

\_\_\_\_\_

\_\_\_\_\_

\_\_\_\_\_



\_\_\_\_\_  
Anthony F. Fremarek, *Supervisor*

\_\_\_\_\_  
Charles H. Willard, *Clerk*

Established 1850

# PLAINFIELD Township

Value the Past • Embrace the Present • Envision the Future



**Supervisor**

**Tony Fremarek**  
815.436.8308 P  
815.436.5117 F

**Trustees**

**Ernie Knight**  
**Debbie Kraulidis**  
**Eric Nelson**  
**Matthew Starr**

**Clerk**

**Chuck Willard**

**Tax Collector**

**Brandon Bernicky**

**Assessor**

**Erin C. Kljaich**  
815.436.5110 P  
815.436.5117 F

**Hwy. Commissioner**

**Ken Marland**  
815.436.6090 P  
815.436.7050 F

**Address**

22525 W. Lockport St.  
Plainfield, IL 60544

**Website**

plainfield-township.com

## MEMO

**TO:** Supervisor and Board of Trustees  
**FROM:** Andi French  
**RE:** Pace Agreement  
**DATE:** December 13, 2017  
**COPY:** Supervisor's Administrative Staff

Pace recently held a meeting at Lockport Township for the Central Will County Dial-a-Ride service area which includes the City of Joliet, and Townships of Homer, Joliet, Lockport, Plainfield, and Troy.

The purpose was to assess the pros and cons of the current program with the sole purpose of determining what changes can be made so fewer riders are turned away. Eliminating the current subscribed riders option and allowing callers to book rides up to seven days in advance vs. the current 24 hours are two options that will not affect the 2018 agreement as presented but may allow for additional rider capacity. Increasing the \$2.00 rider fee and asking the municipalities to pay more annually were additional options discussed. Funding from other entities such as Title XX and UCP also need to be considered.

Further research is needed over the next few months. A tentative March meeting is planned to review additional data.

Thank you.



Thomas J. Ross  
Executive Director

November 9, 2017

Honorable Anthony Fremarek  
Supervisor  
Plainfield Township  
22525 W. Lockport Street  
Plainfield, IL 60544

Dear Supervisor Fremarek:

On November 8, 2017, the Board of Directors approved Pace's 2018 budget which includes funding for dial-a-ride programs. Included in this budget is a modest increase in funding.

Enclosed are two copies of the Dial-A-Ride Local Share Agreement between Pace and Plainfield Township. Also included is the Cost Estimate Worksheet which shows projected costs, ridership, and Pace's 2018 budgeted subsidy for your program.

Your current Subsidy Agreement expires on December 31, 2017. To ensure that your dial-a-ride project can continue, uninterrupted, beginning January 1, 2018, please return the two fully executed original agreements to Pace in the enclosed return envelope no later than Friday, December 22, 2017. Once both agreements are signed by Pace's Executive Director, we will return a fully executed agreement to you.

Please feel free to contact Randy Comstock, Division Manager, at 847-228-4223 if you have any questions regarding this matter. We are looking forward to another year of working with your community to provide dial-a-ride service in your area. Thank you in advance for your cooperation.

Sincerely,

Melinda J. Metzger  
Deputy Executive Director  
Revenue Services

Enclosures

## PACE PARATRANSIT LOCAL SHARE AGREEMENT

*Plainfield Township*

This agreement is made this \_\_\_\_ day of \_\_\_\_\_, 2017 by and between the Suburban Bus Division of the Regional Transportation Authority (RTA) operating under the name and hereinafter referred to as "Pace", an Illinois municipal corporation, and Plainfield Township, an Illinois municipal corporation, hereinafter referred to as the "Municipality".

The parties, in consideration of the mutual promises hereinafter set forth, hereby agree to the following:

1. **TERM** - This agreement will be in effect beginning January 1, 2018 and ending December 31, 2018.
2. **SERVICE DESCRIPTION** - The Municipality will participate in the financial support of the transportation service described in the attached Exhibit A. Exhibit A is hereby incorporated and made a part of this Agreement.
3. **REPORTING** - Pace may provide to the Municipality on a monthly basis, a report with the following:
  - A. Number of one way trips.
  - B. Total Vehicle service hours (provided for Dial-A-Ride service as outlined in Exhibit A of this Agreement).
  - C. A billing for Local Share, determined as outlined in Section 4 of this Agreement.
4. **LOCAL SHARE FUNDING** - The Municipality agrees to reimburse Pace monthly for the Local Share incurred in operating the service described in Exhibit A of this Agreement. The Local Share will be calculated in the following manner:
  - A. The Total Expense of the project will be calculated by multiplying the actual number of vehicle service hours delivered per this Agreement by the hourly rate charged to Pace by the Contractor. Operating Deficit will be defined as Total Expense less fare revenue.
  - B. The Pace Contribution will be the lesser of 1) 75% of the actual Operating Deficit attributed to a maximum of 15,739 vehicle hours of service, or 2) \$754,582. The Local Share shall not exceed \$262,668.

The Pace Contribution shall be calculated monthly on a year-to-date basis to adjust for actual vehicle hours of service and ensure that the annual Pace Contribution is not depleted in advance before the end of the term of this agreement.

The Local Share is the Total Expense, as described in Section 4 A, minus fares, minus the Pace Contribution.

- C. The Local Share is the Total Expense, as described in Section 4. A., minus fares, minus the Pace Contribution. The six participating townships shall pay 40% of the Total Local Share. The 40% of the Total Local Share shall be apportioned among the townships based upon the percentage of ridership by each township's residents. For the purpose of determining the Local Share, residents of the City of Joliet would not be considered residents of the townships.

- D. The Municipality shall pay Pace within thirty (30) days of receiving the monthly bill for the Local Share.
- E. A Cost Estimate Worksheet containing estimated ridership, expenses, fares and Pace subsidy for Net Operating Cost and Call Center Cost is incorporated herein and attached hereto as Exhibit B.

- 5. **AMENDMENT** - This Agreement constitutes the entire Agreement between the parties hereto. Any proposed changes in this Agreement shall be submitted to Pace for its prior approval. Except for minor service changes, no modification, addition, deletion, revision, alteration or other change to this Agreement shall be effective unless and until such changes are reduced to writing and executed by the authorized representatives of parties hereto.
- 6. **TERMINATION** - This contract can be terminated upon thirty (30) calendar days written notice by Pace, if: 1) sufficient funds have not been appropriated to cover the estimated requirements by Pace or by any other agency funding the service; 2) Pace develops alternative public transportation services which, as determined by Pace will better meet the transportation needs of the public; or, 3) the Municipality fails to make payments as required by Section 4 of this agreement.
- 7. **FAILURE TO PERFORM** - Pace will not be responsible for any failure on the part of the Contractor to provide service due to circumstances beyond the reasonable control of the Contractor or Pace. Pace shall make every reasonable effort to have service restored as soon as practical under the circumstances. No fees will be charged for service not performed.

**IN WITNESS WHEREOF**, the parties hereto have caused this Agreement to be made effective and executed as of the date first set forth above by their duly authorized officials.

**SUBURBAN BUS DIVISION OF THE REGIONAL TRANSPORTATION AUTHORITY**

**PACE**

**PLAINFIELD TOWNSHIP**

By: \_\_\_\_\_  
Thomas J. Ross, Executive Director

By: \_\_\_\_\_  
Anthony Fremarek, Supervisor

Date: \_\_\_\_\_

Date: \_\_\_\_\_

Attest: \_\_\_\_\_

Attest: \_\_\_\_\_

Date: \_\_\_\_\_

Date: \_\_\_\_\_

# Exhibit A

## TRANSPORTATION SERVICES

### PLAINFIELD TOWNSHIP

<b>TYPE OF SERVICE</b>	Dial-A-Ride Bus Service
<b>SERVICE OPERATED BY</b>	Pace will contract with a private carrier to provide the following service:
<b>SERVICE HOURS</b>	Monday through Friday, 6:00 a.m. to 5:00 p.m. Additional service may be provided as mutually agreed upon by Pace and the Municipality.
<b>RESERVATION HOURS</b>	Monday through Friday, 6:00 a.m. to 5:00 p.m.
<b>HOLIDAYS</b>	Service will <u>not</u> operate on the following holidays: <ul style="list-style-type: none"><li>• New Year's Day</li><li>• Memorial Day</li><li>• Independence Day</li><li>• Labor Day</li><li>• Thanksgiving Day</li><li>• Christmas Day</li></ul>
<b>RESERVATION METHOD</b>	Reservations will be made by contacting the call center 24 hours in advance of the scheduled trip. Requests for the day of the trip will be honored to the extent that the request can be accommodated within the frame work of the day's schedule.  Service is limited to the number of annual service hours outlined in the Cost Estimate Worksheet.
<b>SUBSCRIPTIONS</b>	Subscriptions are allowed at the discretion of the sponsors provided that no more than 50% of the hourly ridership is subscription rides.
<b>SERVICE AREA</b>	Homer, Joliet, Lockport, Plainfield, Troy Townships
<b>ONE-WAY FARE</b>	\$2.00 per rider per trip
<b>COMPANIONS</b>	Companions are allowed and required to pay the fare.
<b>RIDER ELIGIBILITY</b>	Residents age 60 and older, and/or persons who have a disability.  Verification of eligibility is dictated and mutually agreed upon by the sponsors.

# Exhibit B

## COST ESTIMATE WORKSHEET

### 2018 LOCAL SHARE AGREEMENT

PROJECT: CENTRAL WILL COUNTY

HOURS OF SERVICE	15,739
RIDERSHIP	32,403
EXPENSE	<u>\$1,108,797</u>
REVENUE	<u>\$ 46,985</u>
OPERATING DEFICIT	<u>\$1,061,812</u>
PACE SUBSIDY	<u>\$ 754,582</u>
CALL CENTER GRANT	<u>\$ 44,563</u>
LOCAL SHARE	<u>\$ 262,668</u>
City of Joliet (60%)	<u>\$ 160,116</u>
Homer Township	<u>\$ 15,063</u>
Joliet Township	<u>\$ 25,183</u>
Lockport Township	<u>\$ 28,274</u>
Plainfield Township	<u>\$ 11,725</u>
Troy Township	<u>\$ 22,298</u>



**RESOLUTION #17-05**

**RESOLUTION OF THE PLAINFIELD TOWNSHIP BOARD OF TRUSTEES  
AUTHORIZING THE TOWNSHIP SUPERVISOR TO HIRE AND/OR  
TERMINATE CERTAIN PLAINFIELD TOWNSHIP EMPLOYEES**

**WHEREAS**, the Assessor has the authority to hire employees for and/or terminate employees holding positions in the Office of the Assessor; and

**WHEREAS**, the Highway Commissioner has the authority to hire employees for and/or terminate employees holding positions in the Road District; and

**WHEREAS**, the Township Supervisor has the authority to hire employees for and/or terminate employees holding positions in the Offices of the Supervisor and General Assistance; and

**WHEREAS**, the Plainfield Township Board of Trustees considers it in the best interest of the Township to vest the authority to hire employees for and/or terminate employees holding any positions in the Township except those in the Office of the Assessor or the Road District.

**BE IT HEREBY RESOLVED BY THE PLAINFIELD TOWNSHIP BOARD OF TRUSTEES** as follows:

**Section 1:** That the Plainfield Township Supervisor is authorized to hire employees for and/or terminate employees holding any positions in the Township except those in the Office of the Assessor or the Road District.

**Section 2:** This Resolution is repealed May 17, 2021.

**ADOPTED THIS 13<sup>TH</sup> DAY OF DECEMBER 2017**, at the Township Board meeting duly held in the Township of Plainfield, Will County, Illinois, on a roll call vote as:

<b>Ayes:</b>	<b>Nays:</b>	<b>Pass:</b>	<b>Abstain:</b>	<b>Absent:</b>	
_____	_____	_____	_____	_____	Ernie Knight, Trustee
_____	_____	_____	_____	_____	Debbie Kraulidis, Trustee
_____	_____	_____	_____	_____	Eric Nelson, Trustee
_____	_____	_____	_____	_____	Matthew Starr, Trustee
_____	_____	_____	_____	_____	Anthony Fremarek, Supervisor

By:

\_\_\_\_\_  
Anthony F. Fremarek, Supervisor      Date

Attest:

\_\_\_\_\_  
Charles H. Willard, Clerk      Date

Established 1850

# PLAINFIELD Township

Value the Past • Embrace the Present • Envision the Future



**Supervisor**

**Tony Fremarek**  
815.436.8308 P  
815.436.5117 F

**Trustees**

**Ernie Knight**  
**Debbie Kraulidis**  
**Eric Nelson**  
**Matthew Starr**

**Clerk**

**Chuck Willard**

**Tax Collector**

**Brandon Bernicky**

**Assessor**

**Erin C. Kljaich**  
815.436.5110 P  
815.436.5117 F

**Hwy. Commissioner**

**Ken Marland**  
815.436.6090 P  
815.436.7050 F

**Address**

22525 W. Lockport St.  
Plainfield, IL 60544

**Website**

plainfield-township.com

## 2018 Plainfield Township Cemetery Board Meeting Schedule

Meetings are held the first Wednesday of each month unless otherwise noted.

Plainfield Township Office  
22525 W. Lockport Street  
Plainfield, IL 60544  
6:00 p.m.

Wednesday, January 3, 2018  
Wednesday, April 4, 2018  
Thursday, July 18, 2018\*  
Wednesday, October 3, 2018

\*July Meeting will be held on Wednesday, July 18, 2018 at 6:00 p.m.

Approved December 13, 2017

---

Charles H. Willard, Clerk

# PLAINFIELD AREA CHAMBER OF COMMERCE 2018 COMMUNITY PROFILE & DIRECTORY

## Publication Date

March 2018

## Ad Reservation Deadline

January 5, 2018

## System Ready Ad Deadline

February 5, 2018

## To Place An Ad

Contact:

**Barry Kenis**  
**(630) 479-1526**  
**bkenis@tspubs.com**



*Your Custom Publishing Partner*  
A Daily Herald Media Group Company

## Advertising Rates

Full Page	\$3,295
Half Page	\$1,995
Quarter Page	\$940
Eighth Page	\$625

## Premium Positions

Centerspread	\$4,995
Back Page	\$4,395
Inside Front	\$3,995
Inside Back	\$3,995
Pages 3-5	\$3,595



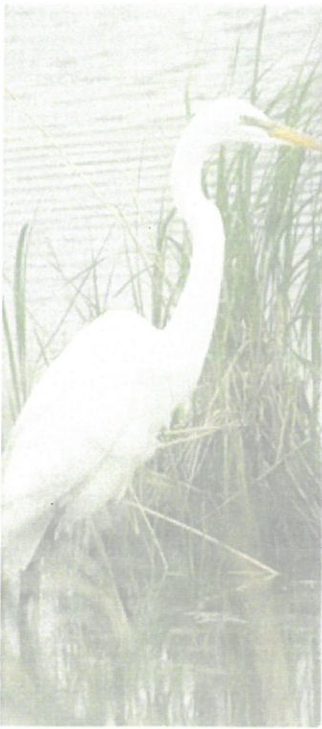

Established 1850

# PLAINFIELD TOWNSHIP

To: Township Board  
From: Erin Kljaich, Assessor  
Date: December 2017  
RE: Monthly Report

***Supervisor***

Tony Fremarek  
815.436.8308

***Assessor***

Erin C. Kljaich  
815.436.5110

***Highway Commissioner***

Kenneth R. Marland  
815.436.6090

***Clerk***

Chuck Willard

***Trustees***

Ernie Knight  
Debbie Kraulidis  
Matthew C. Starr  
Eric Nelson

***Tax Collector***

Brandon Bernicky

Our evidence for all residential and commercial appeals has been submitted to the Will County Board of Review using their digital portal. All hearings, both residential and commercial/industrial, have been held. The Board of Review decisions will be published at the end of January or beginning of February.

I have worked with our assessing software company to improve the data stored about basements. Plus, more detailed basement information has been added to the website.

We have started a new project. The new project adds photos to our assessing software and website. Virtually a limitless amount of photos can be added to the records.

Visit your Assessor's Office - I invite you all to visit the office, shadow my team, meet team members, learn about the process and interact with taxpayers. We would love to have you anytime M-F 8am-4pm.

Plainfield Township Highway Department  
Report for December 13, 2017

1. Leaf Pick Up and Spreading of Leaves

The Leaf Pick Up was scheduled to start on Monday, October 23, and end on Friday, November 17, 2017. Due to inclement weather and a lack of dropped leaves, leaf pick up was delayed until Wednesday, October 25. During the first three weeks of the program, only 11 loads of leaves were picked up. Starting the fourth week, leaves were plentiful, and a total of 44 loads were picked up. Commissioner Marland also added extra pick up days that included the three days before Thanksgiving and the week after Thanksgiving. When we finished the last pick up day on November 29, a total of 122 loads were picked up for the year. This was 58 loads less than last year. Most of the leaves were transported to the Nelson farm on Wheeler Road and County Line Road. A spreader wagon was used to spread the leaves.

2. Shoulder Gravel

The Highway Department worked on November 1 and 2 reapplying shoulder gravel to Budler/135<sup>th</sup> Street and 143<sup>rd</sup> Street. This was necessitated by the heavy rains we had on October 14 and 15, 2017.

3. New Four-Way Stop Sign

The Highway Department, in cooperation with Plainfield Schools, installed four stop signs at the corner of Budler Road and Lakeland Trail in Lakewood Falls. This four-way stop will provide additional safety for both elementary schools located in that area.

4. Winter Truck Maintenance

All Highway Department trucks have been maintained, cleaned, and snow-removing equipment attached in preparation for the winter season.



## Administrator's Report

December 13, 2017

- Passports: A handful of appointments have been scheduled for the past month during the expanded Tuesday hours. Social media or the website is the most common source of where people are learning about us. The Township services brochure is given to each person before they leave and we ask that they help spread the word about this service. All staff members are now trained to process applications.

Passports processed in 2016	176
Passports processed to date in 2017	132

- Marriage Licenses:

Marriage licenses processed in 2016	212
Marriage licenses processed to date in 2017	248

- Building Renovations: Schematic drawings from the architect were recently received and under review.
- Website: Wendi and Lori have reviewed and updated all the website content for our office and shared it with Collector Bernicky for the new website.
- Notary Services: Clerk Willard, Wendi, and Christy recently became certified through the Illinois Secretary of State's Office to notarize documents. This service will continue to be offered by appointment, however; since there are four of us now who are able to notarize documents, this helps with the occasional resident who walks in.
- Cemetery: Lisa has spent time learning and formatting the CIMS (Cemetery Information Management System) software and entering data from the cemetery files. She has trained Lori to assist and will teach additional staff members as time permits. As with anything new, there have been a few hiccups but Lisa has been communicating with Ken Carroll to work through the issues.
- HR: Christy is working on closing out the payroll for the year and getting the W-2's and 1099's ready as well as finalizing all the new health care-related paperwork for the January 1, 2018 renewal.

### *Supervisor*

**Tony Fremarek**  
815.436.8308 P  
815.436.5117 F

### *Trustees*

**Ernie Knight**  
**Debbie Kraulidis**  
**Eric Nelson**  
**Matthew Starr**

### *Clerk*

**Chuck Willard**

### *Tax Collector*

**Brandon Bernicky**

### *Assessor*

**Erin C. Kljaich**  
815.436.5110 P  
815.436.5117 F

### *Hwy. Commissioner*

**Ken Marland**  
815.436.6090 P  
815.436.7050 F

### *Address*

22525 W. Lockport St.  
Plainfield, IL 60544

### *Website*

plainfield-township.com

**Donation Request History**  
**\$250-National (N); \$500-Local Civic (LC); \$1,000- Local Service (LS)**

Category	Cap	Organization	2011	2012	2013	2014	2015	2016	2017
LC	\$ 500	American Cancer Society (Relay for Life)	\$ 500	\$ 500	\$ 500	\$ 500	\$ 500	\$ 500	
			June	May	July	June	May	June	
LS	\$ 1,000	American Legion Post #13 (War Memorial in Settler's Park)	\$ -	\$ -	\$ -	\$ -	\$ -	\$ 2,500	
								March	
LC	\$ 500	Big Brothers Big Sisters Will/Grundy	\$ -	\$ -	\$ -	\$ -	\$ 500		
								April	
LS	\$ 1,000	CASA of Will County	\$ -	\$ 1,000	\$ 1,000	\$ 1,000	\$ 1,000	\$ 1,000	
				May	May	July	September	November	
LS	\$ 1,000	Chicagoland Angels Pop Warner Cheer	\$ -	\$ 1,000	\$ -	\$ 1,000	\$ 1,000		\$ 1,000
				November		June	November		June
LS	\$ 1,000	Crisis Line of Will County	\$ -	\$ -	\$ -	\$ -	\$ -	\$ 1,000	
								January	
LC	\$ 500	CW Avery Family YMCA	\$ -	\$ 500	\$ -	\$ 500	\$ -		
				March		February			
LC	\$ 500	Foundation of Excellence "The Great Read"	\$ 150	\$ 250	\$ 250	\$ 250	\$ 300	\$ 500	\$ 500
			February	February	March	March	March	March	February
LC	\$ 500	Green Harvest	\$ -	\$ -	\$ -	\$ -	\$ -	\$ 500	
								July	
LS	\$ 1,000	Joliet Area Community Hospice	\$ 1,000	\$ 1,000	\$ -	\$ 1,000	\$ 1,000		
			May	August		August	December		
N	\$ 250	March of Dimes	\$ -	\$ -	\$ -	\$ -	\$ -	\$ 250	\$ 250
								February	February
LC	\$ 500	Northern Illinois Food Bank	\$ -	\$ -	\$ -	\$ -	\$ -	\$ 500	\$ 500
								April	July
LC	\$ 500	Plainfield Area Community Chorus	\$ 500	\$ 500	\$ 500	\$ 500	\$ 500	\$ 500	\$ 500
			June	July	August	September	July	September	September
LS	\$ 500	Plainfield Junior Women's Club							\$ 500
									February
LC	\$ 500	Plainfield Library Summer Reading Pgm.	\$ -	\$ 250	\$ 250	\$ 250	\$ -		
				March	March	May			
LC	\$ 500	Plainfield Lions Club	\$ 500	\$ 500	\$ 500	\$ 500	\$ 500	\$ 500	\$ 500
			November	November	November	November	November	November	November
LS	\$ 1,000	Plainfield Park District - Patriotic Picnic	\$ -	\$ 700	\$ 700	\$ 700	\$ 1,000	\$ 1,000	\$ 1,000
				April	July	June	February	February	February
LC	\$ 500	Ready, Set, Ride	\$ 800	\$ -	\$ 300	\$ 300	\$ -	\$ 500	
			July/October		October	December		December	
LS	\$ 1,000	REACH Ministries	\$ -	\$ -	\$ -	\$ -	\$ 1,000		
							October		
LC	\$ 500	Senior Services Center	\$ 1,000	\$ -	\$ 1,000	\$ 1,000	\$ 1,000	\$ 1,000	
			August		March	April	April	April	
LC	\$ 500	Team Make a Difference	\$ -	\$ -	\$ -	\$ -	\$ -	\$ 500	
								July	
LS	\$ 1,000	University of IL Extension	\$ -	\$ 300	\$ 100	\$ -	\$ 100		
				November	November		May		
LS	\$ 1,000	Will County Cntr. for Cmty. Concerns	\$ -	\$ -	\$ 1,000	\$ -	\$ -	\$ 1,000	\$ 1,000
					July			May	November
LS	\$ 1,000	Will-Grundy Medical Center	\$ -	\$ -	\$ -	\$ -	\$ 1,000		\$ 1,000
					July		December		August
		<b>Fiscal Year Donation Totals</b>	<b>\$ 4,450</b>	<b>\$ 6,500</b>	<b>\$ 6,100</b>	<b>\$ 7,500</b>	<b>\$ 9,400</b>	<b>\$ 11,750</b>	<b>\$ 6,750</b>

**PLAINFIELD TOWNSHIP  
BOARD AUDIT REPORT  
FROM: 11/09/2017 TO: 12/13/2017**

TOTAL PAYROLL TOWN FUND.....	\$ 59,891.03
TOTAL BOARD AUDIT REPORT TOWN FUND.....	\$ <u>28,812.77</u>
TOTAL GENERAL TOWN FUND.....	\$ 88,703.80
TOTAL PAYROLL HIGHWAY.....	\$ 28,820.27
TOTAL BOARD AUDIT REPORT HIGHWAY.....	\$ <u>22,907.69</u>
TOTAL ROAD AND BRIDGE FUND.....	\$ 51,727.96
*****TOTAL ALL FUNDS*****	<u>\$ 140,431.76</u>

THE ABOVE HAS BEEN AUDITED AND APPROVED FOR PAYMENT THIS \_\_\_\_\_  
DAY OF \_\_\_\_\_, 2017.

\_\_\_\_\_  
Supervisor

\_\_\_\_\_  
Town Clerk

\_\_\_\_\_  
Trustee

\_\_\_\_\_  
Trustee

\_\_\_\_\_  
Trustee

\_\_\_\_\_  
Trustee

\_\_\_\_\_  
Highway Commissioner

**Plainfield Township**  
**Board Audit Report- TOWNSHIP**  
 November 9 through December 13, 2017

Date	Num	Memo	Account	Class	Paid Amount
<b>A T &amp; T - Cemetery</b>					
11/20/2017	11/28/2017	Cemetery Phone/Internet	103532 · Telephone/...	TOWNSHIP:CEMETERY	-147.04
Total A T & T - Cemetery					-147.04
<b>Advantica</b>					
12/06/2017	32585	Vision Insurance - Assessor Share	100268 · Health- Po...	TOWNSHIP:ASSESSOR	-37.20
12/06/2017	32585	Vision Insurance - Cemetery Share	100268 · Health- Po...	TOWNSHIP:CEMETERY	-20.06
12/06/2017	32585	Vision Insurance - Supervisor Share	100268 · Health- Po...	TOWNSHIP:SUPERVISOR	-18.60
Total Advantica					-75.86
<b>AITCOY</b>					
11/20/2017	2018 Membership	2018 Membership Dues for Matt Starr	101574 · Youth Serv...	TOWNSHIP:SUPERVISOR	-75.00
Total AITCOY					-75.00
<b>Ajax Linen-Township</b>					
11/20/2017	938815	Floor Mats for Township	101579 · Operating ...	TOWNSHIP:SUPERVISOR	-37.26
11/20/2017	934981, 936795, 9388	Floor Mats for Community Center	101589 · Des Plaine...	TOWNSHIP:SUPERVISOR	-82.53
Total Ajax Linen-Township					-119.79
<b>American Homes 4 Rent, LLC.</b>					
11/20/2017	GA-201762	Emergency Assistance - #201762	101591 · Gen Assist ...	TOWNSHIP:SUPERVISOR	-300.00
Total American Homes 4 Rent, LLC.					-300.00
<b>Amerigas</b>					
11/20/2017	3070915078	Propane - Town Share	101544 · Util-Electric...	TOWNSHIP:SUPERVISOR	-571.55
12/13/2017	3071888478	Propane - Town Share	101544 · Util-Electric...	TOWNSHIP:SUPERVISOR	-721.80
Total Amerigas					-1,293.35
<b>AT &amp; T- Township</b>					
11/20/2017	10/28/2017	Office Phone Through November 28 - Town	101532 · Telephone/...	TOWNSHIP:SUPERVISOR	-110.64
Total AT & T- Township					-110.64
<b>C. M. Lavoie and Associates, Inc.</b>					
11/20/2017	10316	Task 5.4 Plat of Survey	103520 · Bldg/Equip/...	TOWNSHIP:CEMETERY	-200.00
Total C. M. Lavoie and Associates, Inc.					-200.00
<b>Comcast Cable</b>					
11/20/2017	11/01/2017	Backup Internet	101532 · Telephone/...	TOWNSHIP:SUPERVISOR	-159.35
Total Comcast Cable					-159.35
<b>ComEd-Siren</b>					
11/20/2017	12/01/2017	Tornado Siren	101544 · Util-Electric...	TOWNSHIP:SUPERVISOR	-35.02
Total ComEd-Siren					-35.02
<b>Cross Points Sales, Inc.</b>					
11/20/2017	33756	Annual Fire Alarm System Monitoring PTCC	101589 · Des Plaine...	TOWNSHIP:SUPERVISOR	-600.00
Total Cross Points Sales, Inc.					-600.00
<b>Cutting Edge Lawn Care</b>					
11/20/2017	37537	Monthly Landscape Maintenance	101520 · Bldg./Equip...	TOWNSHIP:SUPERVISOR	-324.00
Total Cutting Edge Lawn Care					-324.00
<b>First Midwest Bank/Bankcard Processing Ce</b>					
11/20/2017	Through 11/07/2017	Cloud 9	101564 · IT-SUPER	TOWNSHIP:SUPERVISOR	-175.80
11/20/2017	Through 11/07/2017	Operating Supplies	101579 · Operating ...	TOWNSHIP:SUPERVISOR	-289.63
11/20/2017	Through 11/07/2017	Record Massey Avenue Road Vacation	103590 · Misc Exp-C...	TOWNSHIP:CEMETERY	-44.25
11/20/2017	Through 11/07/2017	Miscellaneous Office Supplies	102578 · Office Sup...	TOWNSHIP:ASSESSOR	-133.88
Total First Midwest Bank/Bankcard Processing Ce					-643.56
<b>Fleet Card (Voyager Fleet Systems, Inc.)</b>					
11/20/2017	869216416745	Shuttle Bus Fuel	101580 · Shuttle Fue...	TOWNSHIP:SUPERVISOR	-1,594.17
Total Fleet Card (Voyager Fleet Systems, Inc.)					-1,594.17
<b>GA-AT&amp;T</b>					
11/20/2017	GA - 201770	Emergency Assistance - #201770	101594 · Home Reli...	TOWNSHIP:SUPERVISOR	-135.39
Total GA-AT&T					-135.39
<b>GA-ComEd</b>					
11/20/2017	GA-201764	General Assistance - #201764	101594 · Home Reli...	TOWNSHIP:SUPERVISOR	-45.00
Total GA-ComEd					-45.00
<b>GA-Nicor</b>					
11/20/2017	GA-201764	General Assistance - #201764	101594 · Home Reli...	TOWNSHIP:SUPERVISOR	-7.00
Total GA-Nicor					-7.00
<b>GA-Village of Romeoville</b>					
11/20/2017	GA - 201764	General Assistance - #201764	101594 · Home Reli...	TOWNSHIP:SUPERVISOR	-100.92
Total GA-Village of Romeoville					-100.92
<b>Groot Industries</b>					
11/20/2017	15419765	Recycle Service	101520 · Bldg./Equip...	TOWNSHIP:SUPERVISOR	-53.19
12/13/2017	15471954	Cemetery Dumpster	103520 · Bldg/Equip/...	TOWNSHIP:CEMETERY	-213.82
Total Groot Industries					-267.01
<b>Healthcare Service Corp. (BCBS)</b>					

**Plainfield Township**  
**Board Audit Report- TOWNSHIP**  
 November 9 through December 13, 2017

Date	Num	Memo	Account	Class	Paid Amount
12/13/2017	32588	Health Insurance - Assessor Share	100268 · Health- Po...	TOWNSHIP:ASSESSOR	-3,814.84
12/13/2017	32588	Health Insurance - Cemetery Share	100268 · Health- Po...	TOWNSHIP:CEMETERY	-776.13
12/13/2017	32588	Health Insurance - Supervisor Share	100268 · Health- Po...	TOWNSHIP:SUPERVISOR	-2,167.19
<b>Total Healthcare Service Corp. (BCBS)</b>					<b>-6,758.16</b>
<b>Herald News</b>					
11/20/2017	Annual Renwal	Annual Renewal	101538 · Dues/Subs...	TOWNSHIP:SUPERVISOR	-130.00
<b>Total Herald News</b>					<b>-130.00</b>
<b>IMRF</b>					
12/13/2017	32589	IMRF - Cemetery Share	100264 · IMRF Paya...	TOWNSHIP:CEMETERY	-124.18
12/13/2017	32589	IMRF - Supervisor Share	100264 · IMRF Paya...	TOWNSHIP:SUPERVISOR	-1,109.40
12/13/2017	32589	IMRF - Assessor Share	100264 · IMRF Paya...	TOWNSHIP:ASSESSOR	-414.22
12/13/2017	32590	IMRF - Super Share	100264 · IMRF Paya...	TOWNSHIP:SUPERVISOR	-2,650.22
<b>Total IMRF</b>					<b>-4,298.02</b>
<b>IMRF VAC</b>					
12/13/2017	32594	IMRF - Assessor Share	100264 · IMRF Paya...	TOWNSHIP:ASSESSOR	-671.83
12/13/2017	32595	IMRF - Supervisor VAC	100264 · IMRF Paya...	TOWNSHIP:SUPERVISOR	-1,413.73
<b>Total IMRF VAC</b>					<b>-2,085.56</b>
<b>Joliet Water Reconditioning</b>					
11/20/2017	11/15/2017	Water Softener Salt	101520 · Bldg./Equip...	TOWNSHIP:SUPERVISOR	-90.00
<b>Total Joliet Water Reconditioning</b>					<b>-90.00</b>
<b>Kin-Ko Ace Store #4300</b>					
11/20/2017	631993/6	White Marking Paint	103520 · Bldg/Equip/...	TOWNSHIP:CEMETERY	-15.18
<b>Total Kin-Ko Ace Store #4300</b>					<b>-15.18</b>
<b>Konica Minolta USA, Inc.</b>					
11/20/2017	10/31/2017	Copier Usage through 10/15/2017 - Supervisor Share	101520 · Bldg./Equip...	TOWNSHIP:SUPERVISOR	-39.83
11/20/2017	10/31/2017	Copier Usage through 10/15/2017 - Assessor Share	102520 · Maint Svc-...	TOWNSHIP:ASSESSOR	-39.83
11/20/2017	10/31/2017	Copier Usage through 10/15/2017 - PTCC Share	101589 · Des Plaine...	TOWNSHIP:SUPERVISOR	-101.64
11/20/2017	9004027107	Community Center Copy Machine	101589 · Des Plaine...	TOWNSHIP:SUPERVISOR	-57.06
<b>Total Konica Minolta USA, Inc.</b>					<b>-238.36</b>
<b>Menards</b>					
11/20/2017	18983	Supplies	101520 · Bldg./Equip...	TOWNSHIP:SUPERVISOR	-89.11
11/20/2017	18798	Supplies	103520 · Bldg/Equip/...	TOWNSHIP:CEMETERY	-14.98
<b>Total Menards</b>					<b>-104.09</b>
<b>Midco</b>					
11/20/2017	319997	Reprogram Office Phones	101532 · Telephone/...	TOWNSHIP:SUPERVISOR	-450.00
<b>Total Midco</b>					<b>-450.00</b>
<b>Napa Auto Parts- Town</b>					
11/20/2017	850206, 850268	Gas Can	103520 · Bldg/Equip/...	TOWNSHIP:CEMETERY	-39.96
11/20/2017	850206, 850268	Miscellaneous Supplies	103520 · Bldg/Equip/...	TOWNSHIP:CEMETERY	-272.43
<b>Total Napa Auto Parts- Town</b>					<b>-312.39</b>
<b>Narvick</b>					
11/20/2017	56868, 53312	Cemetery Concrete	103584 · Conc Foun...	TOWNSHIP:CEMETERY	-342.50
11/20/2017	56868, 53312	Cemetery Concrete	103584 · Conc Foun...	TOWNSHIP:CEMETERY	-642.00
12/13/2017	57041	Cemetery Concrete	103584 · Conc Foun...	TOWNSHIP:CEMETERY	-548.50
<b>Total Narvick</b>					<b>-1,533.00</b>
<b>Nationwide 457</b>					
12/13/2017	32587	Nationwide - Assessor Share	100266 · Def. Comp ...	TOWNSHIP:ASSESSOR	-325.00
<b>Total Nationwide 457</b>					<b>-325.00</b>
<b>NCPERS Group Life Insurance</b>					
12/13/2017	32586	Life Insurance - Assessor Share	100265 · NCPERS L...	TOWNSHIP:ASSESSOR	-32.00
12/13/2017	32586	Life Insurance - Cemetery Share	100265 · NCPERS L...	TOWNSHIP:CEMETERY	-16.00
12/13/2017	32586	Life Insurance - Supervisor Share	100265 · NCPERS L...	TOWNSHIP:SUPERVISOR	-16.00
<b>Total NCPERS Group Life Insurance</b>					<b>-64.00</b>
<b>Off The Press</b>					
11/20/2017	21216	Business Cards	101536 · Printing-SU...	TOWNSHIP:SUPERVISOR	-36.00
<b>Total Off The Press</b>					<b>-36.00</b>
<b>Pace Suburban Bus</b>					
11/20/2017	489877	August 2017 Local Share	101576 · Handicap T...	TOWNSHIP:SUPERVISOR	-783.84
<b>Total Pace Suburban Bus</b>					<b>-783.84</b>
<b>Plainfield Lions Club</b>					
11/20/2017	10/17/2017	Donation	101566 · Comm. Ser...	TOWNSHIP:SUPERVISOR	-500.00
<b>Total Plainfield Lions Club</b>					<b>-500.00</b>
<b>Ready Refresh-Town</b>					
11/20/2017	17J8103644145	Drinking Water through 10/31/2017	101578 · Office Sup...	TOWNSHIP:SUPERVISOR	-36.70
12/13/2017	17K8103644145	Drinking Water through 11/30/2017	101578 · Office Sup...	TOWNSHIP:SUPERVISOR	-36.70
<b>Total Ready Refresh-Town</b>					<b>-73.40</b>
<b>RWK Design</b>					
11/20/2017	4107	Monthly Billing for November 2017 - Cloud, 0365, Email -Super	101564 · IT-SUPER	TOWNSHIP:SUPERVISOR	-262.49
11/20/2017	4107	Monthly Billing for November 2017 - Cloud, 0365, Email -Assessor	102549 · Web/Comp...	TOWNSHIP:ASSESSOR	-262.49
11/20/2017	4026	Monthly Billing for October 2017 - Cloud, 0365, Email - Super	101564 · IT-SUPER	TOWNSHIP:SUPERVISOR	-262.49

**Plainfield Township**  
**Board Audit Report- TOWNSHIP**  
**November 9 through December 13, 2017**

Date	Num	Memo	Account	Class	Paid Amount
11/20/2017	4026	Monthly Billing for October 2017 - Cloud, 0365, Email - Assessor	102549 · Web/Comp...	TOWNSHIP:ASSESSOR	-262.49
Total RWK Design					-1,049.96
<b>Senesac &amp; Lennon, LTD</b>					
11/20/2017	October 2017	QuickBooks Consulting Services	101524 · Accounting...	TOWNSHIP:SUPERVISOR	-1,092.50
Total Senesac & Lennon, LTD					-1,092.50
<b>Staples Advantage</b>					
12/13/2017	8047597801	Miscellaneous Office Supplies - SUPER Share	101578 · Office Sup...	TOWNSHIP:SUPERVISOR	-14.29
12/13/2017	8047597801	Miscellaneous Office Supplies - ASSESSOR Share	102578 · Office Sup...	TOWNSHIP:ASSESSOR	-9.95
Total Staples Advantage					-24.24
<b>Starr.Matthew</b>					
11/20/2017	November	Reimbursement for TOI Conference	101542 · Train/Mtg/...	TOWNSHIP:SUPERVISOR	-178.69
11/20/2017	November	REimbursement for TOI Conference	101542 · Train/Mtg/...	TOWNSHIP:SUPERVISOR	-73.77
Total Starr.Matthew					-252.46
<b>Verizon- Township</b>					
11/20/2017	9795522278	Shuttle Bus Phones	101532 · Telephone/...	TOWNSHIP:SUPERVISOR	-100.83
Total Verizon- Township					-100.83
<b>Village of Plainfield</b>					
11/20/2017	10/31/2017	Water - Cemetery	103544 · Utilities-CE...	TOWNSHIP:CEMETERY	-174.97
Total Village of Plainfield					-174.97
<b>Waste Management</b>					
11/20/2017	GA-201764	General Assistance - #201764	101594 · Home Reli...	TOWNSHIP:SUPERVISOR	-67.08
Total Waste Management					-67.08
<b>Will County Center for Community Concerns</b>					
11/20/2017	11/08/2017	Donation	101566 · Comm. Ser...	TOWNSHIP:SUPERVISOR	-1,000.00
Total Will County Center for Community Concerns					-1,000.00
<b>Willard.Charles</b>					
11/20/2017	November 2017	Reimbursement for TOI Conference	101542 · Train/Mtg/...	TOWNSHIP:SUPERVISOR	-174.96
11/20/2017	November 2017	Reimbursement for TOI Conference	101542 · Train/Mtg/...	TOWNSHIP:SUPERVISOR	-32.55
Total Willard.Charles					-207.51
<b>WMK LLC</b>					
11/20/2017	RO#PLN-147827	Replacement of Pump Housing	101559 · Shuttle Mai...	TOWNSHIP:SUPERVISOR	-813.12
Total WMK LLC					-813.12
<b>TOTAL</b>					<b>-28,812.77</b>

**Plainfield Township**  
**Gross TOWNSHIP Payroll by Employee by Class**

12/08/17

Cash Basis

November 9 through December 13, 2017

	ASSESSOR (TOWNSHIP)	CEMETERY (TOWNSHIP)	SUPERVISOR (TOWNSHIP)	Total TOWNSHIP	TOTAL
Alyinovich, Joseph P.	0.00	0.00	1,106.85	1,106.85	1,106.85
Bernicky, Brandon J.	0.00	0.00	53.82	53.82	53.82
Carey, Thomas E.	0.00	125.57	0.00	125.57	125.57
Carroll, Kenneth	0.00	3,873.09	0.00	3,873.09	3,873.09
Cobb, Jimmie R.	0.00	409.49	0.00	409.49	409.49
Fremarek, Anthony F.	0.00	0.00	2,603.78	2,603.78	2,603.78
French, Andi L.	0.00	0.00	8,140.00	8,140.00	8,140.00
French, Crysta N.	0.00	0.00	828.10	828.10	828.10
French, Stephanie N.	0.00	0.00	828.08	828.08	828.08
Gardner, Lori A	0.00	0.00	2,466.19	2,466.19	2,466.19
Kijaich, Erin	0.00	0.00	6,225.86	6,225.86	6,225.86
Knight, Ernest C.	0.00	0.00	731.13	731.13	731.13
Kraulidis, Debbie L.	0.00	0.00	731.13	731.13	731.13
Kujath, Vernon E.	2,196.06	0.00	0.00	2,196.06	2,196.06
Lee, Rose C.	580.94	0.00	0.00	580.94	580.94
Lockhart, James A.	0.00	0.00	1,090.89	1,090.89	1,090.89
Marland, Kenneth R.	0.00	0.00	8,297.15	8,297.15	8,297.15
McKenzie, Wendi	0.00	0.00	3,097.31	3,097.31	3,097.31
Nelson, Eric D.	0.00	0.00	731.13	731.13	731.13
Olson, Christopher	0.00	0.00	656.57	656.57	656.57
Potocki, Lisa L	0.00	0.00	501.10	501.10	501.10
Reinhart, Jr., Charles E.	0.00	0.00	731.99	731.99	731.99
Schuerman, David M.	4,829.69	0.00	0.00	4,829.69	4,829.69
Stanley, Donna	3,553.93	0.00	0.00	3,553.93	3,553.93
Starr, Matthew C.	0.00	0.00	731.13	731.13	731.13
Surges, Nicholas R.	4,936.58	0.00	0.00	4,936.58	4,936.58
Willard, Charles	0.00	0.00	1,184.15	1,184.15	1,184.15
Woolley, Christy A.	0.00	0.00	2,424.82	2,424.82	2,424.82
No name	-2,907.24	-578.84	-289.42	-3,775.50	-3,775.50
<b>TOTAL</b>	<b>13,189.96</b>	<b>3,829.31</b>	<b>42,871.76</b>	<b>59,891.03</b>	<b>59,891.03</b>

# Plainfield Township Board Audit Report- ROAD AND BRIDGE

November 9 through December 13, 2017

Date	Num	Memo	Account	Class	Paid Amount
<b>A Beep</b>					
11/20/2017	76146	Truck Radios for December	303522 · Maint Svc-Equip.-HW3	HIGHWAY:Highway-HW3	-366.91
Total A Beep					-366.91
<b>Advantica</b>					
12/06/2017	32585	Vision Insurance - Highway Share	100268 · Health- Pop 125	HIGHWAY:Highway-HW3	-45.13
Total Advantica					-45.13
<b>Airgas USA, LLC</b>					
12/13/2017	9062129160	Maintain Service Equipment	303522 · Maint Svc-Equip.-HW3	HIGHWAY:Highway-HW3	-147.85
Total Airgas USA, LLC					-147.85
<b>AJAX Uniform Rentals</b>					
12/13/2017	940686	Uniforms and Mats	303549 · Operating Supplies-HW3	HIGHWAY:Highway-HW3	-71.96
12/13/2017	942561	Uniforms and Mats	303549 · Operating Supplies-HW3	HIGHWAY:Highway-HW3	-71.96
Total AJAX Uniform Rentals					-143.92
<b>Amerigas</b>					
11/20/2017	3070915078	Propane - HWY Share	301545 · Utilities-Propane-HW	HIGHWAY	-571.55
12/13/2017	3071888478	Propane - HWY Share	301545 · Utilities-Propane-HW	HIGHWAY:Highway-HW1	-481.20
Total Amerigas					-1,052.75
<b>Aramark</b>					
12/13/2017	20486605	Shirts for Highway Workers	303549 · Operating Supplies-HW3	HIGHWAY:Highway-HW3	-128.55
Total Aramark					-128.55
<b>AT &amp; T- Highway</b>					
12/13/2017	815436609011	Office Phones	301532 · Telephone/Cell Phones-HW	HIGHWAY:Highway-HW1	-129.04
Total AT & T- Highway					-129.04
<b>Bonnell Industries Inc.</b>					
12/13/2017	0176859-IN	Supplies	303545 · Maint Supplies-Road-HW3	HIGHWAY:Highway-HW3	-397.70
Total Bonnell Industries Inc.					-397.70
<b>Boughton Materials</b>					
11/20/2017	254057	Gravel	303545 · Maint Supplies-Road-HW3	HIGHWAY:Highway-HW3	-87.40
12/13/2017	254359	Gravel	303525 · Maint Svc-Road-HW3	HIGHWAY:Highway-HW3	-287.28
Total Boughton Materials					-374.68
<b>Certified Laboratories</b>					
11/20/2017	2916256	Power Gloss	303549 · Operating Supplies-HW3	HIGHWAY:Highway-HW3	-982.59
12/13/2017	2933957		303549 · Operating Supplies-HW3	HIGHWAY:Highway-HW3	-267.77
Total Certified Laboratories					-1,250.36
<b>Cintas First Aid and Safety</b>					
12/13/2017	9019905133	Replish First Aid Supplies	303549 · Operating Supplies-HW3	HIGHWAY:Highway-HW3	-81.60
Total Cintas First Aid and Safety					-81.60
<b>ComEd2883</b>					
11/20/2017	10/10 - 11/8/...	McKenna Drive Street Lights	303539 · Street Lights-HW3	HIGHWAY:Highway-HW3	-65.15
Total ComEd2883					-65.15
<b>ComEd3875 (Bridge St. Lights)</b>					
12/13/2017	10/17 - 11/1/...	Bridge Street Lights	303539 · Street Lights-HW3	HIGHWAY:Highway-HW3	-72.12
Total ComEd3875 (Bridge St. Lights)					-72.12
<b>ComEd4370</b>					
12/13/2017	10/18 - 11/1/...	Renwick Road Street Lights	303539 · Street Lights-HW3	HIGHWAY:Highway-HW3	-146.87
Total ComEd4370					-146.87
<b>Environmental Recycling and Disposal</b>					
12/13/2017	134577	Environmental Fuel Surcharge	303535 · Utilities-HW3	HIGHWAY:Highway-HW3	-225.95
Total Environmental Recycling and Disposal					-225.95
<b>Healthcare Service Corp. (BCBS)</b>					
12/13/2017	32588	Health Insurance - Highway Share	100268 · Health- Pop 125	HIGHWAY:Highway-HW3	-3,874.07
Total Healthcare Service Corp. (BCBS)					-3,874.07
<b>Heritage FS, Inc.</b>					
11/20/2017	67767	Gasoline and Diesel Fuel	303553 · Automotive Fuel/Oil-HW3	HIGHWAY:Highway-HW3	-1,166.72
12/13/2017	67844	Truck Fuel	303553 · Automotive Fuel/Oil-HW3	HIGHWAY:Highway-HW3	-1,083.78
Total Heritage FS, Inc.					-2,250.50
<b>Home Depot Credit Services</b>					
11/20/2017	8034589, 31...	Miscellaneous Supplies	303549 · Operating Supplies-HW3	HIGHWAY:Highway-HW3	-39.75
11/20/2017	1030849, OA...	Miscellaneous Supplies	303549 · Operating Supplies-HW3	HIGHWAY:Highway-HW3	-9.54
11/20/2017	1030849, OA...	Miscellaneous Supplies	303549 · Operating Supplies-HW3	HIGHWAY:Highway-HW3	-59.27
11/20/2017	1030849, OA...	Miscellaneous Supplies	303549 · Operating Supplies-HW3	HIGHWAY:Highway-HW3	9.54
12/13/2017	7031866	Operating Supplies	303549 · Operating Supplies-HW3	HIGHWAY:Highway-HW3	-14.69
12/13/2017	2032249	Operating Supplies	303549 · Operating Supplies-HW3	HIGHWAY:Highway-HW3	-33.74
12/13/2017	8080105	Operating Supplies	303549 · Operating Supplies-HW3	HIGHWAY:Highway-HW3	-28.21
12/13/2017	8034589	Operating Supplies	303549 · Operating Supplies-HW3	HIGHWAY:Highway-HW3	-8.89
12/13/2017	8034589	Operating Supplies	303549 · Operating Supplies-HW3	HIGHWAY:Highway-HW3	-9.54
12/13/2017	8034589	Operating Supplies	303549 · Operating Supplies-HW3	HIGHWAY:Highway-HW3	9.54
12/13/2017	3194425	Operating Supplies	303549 · Operating Supplies-HW3	HIGHWAY:Highway-HW3	-21.32
12/13/2017	1030849	Operating Supplies	303549 · Operating Supplies-HW3	HIGHWAY:Highway-HW3	-68.81

**Plainfield Township**  
**Board Audit Report- ROAD AND BRIDGE**  
 November 9 through December 13, 2017

Date	Num	Memo	Account	Class	Paid Amount
Total Home Depot Credit Services					-274.68
<b>IMRF</b>					
12/13/2017	32589	IMRF - HWY Share	100264 · IMRF Payable	HIGHWAY:Highway-HW3	-999.50
Total IMRF					-999.50
<b>Interstate All Battery Center</b>					
12/13/2017	1915201019...	Batteries	303543 · Maint Supply-Equip-HW3	HIGHWAY:Highway-HW3	-229.90
Total Interstate All Battery Center					-229.90
<b>Kankakee Truck Equipment Inc.</b>					
12/13/2017	168366	Equipment Service	303522 · Maint Svc-Equip.-HW3	HIGHWAY:Highway-HW3	-439.69
Total Kankakee Truck Equipment Inc.					-439.69
<b>Kin-Ko Ace Store #4300</b>					
11/20/2017	632015	Clamps and Fasteners	303549 · Operating Supplies-HW3	HIGHWAY:Highway-HW3	-21.77
Total Kin-Ko Ace Store #4300					-21.77
<b>Konica Minolta USA, Inc.</b>					
11/20/2017	10/31/2017	Copier Usage through 10/15/2017 - Highway Share	301543 · Maintenance-HW	HIGHWAY:Highway-HW1	-39.82
Total Konica Minolta USA, Inc.					-39.82
<b>Mahoney, Silverman and Cross</b>					
12/13/2017	36107		301526 · Legal Fees-HW	HIGHWAY:Highway-HW1	-97.50
Total Mahoney, Silverman and Cross					-97.50
<b>Mark-It Striping, Inc.</b>					
12/13/2017	217216	Painting Stripes on Road	303525 · Maint Svc-Road-HW3	HIGHWAY:Highway-HW3	-2,550.00
Total Mark-It Striping, Inc.					-2,550.00
<b>Menards</b>					
12/13/2017	18629		303543 · Maint Supply-Equip-HW3	HIGHWAY:Highway-HW3	-21.04
12/13/2017	20174	Plywood Sheathing	303525 · Maint Svc-Road-HW3	HIGHWAY:Highway-HW3	-41.47
Total Menards					-62.51
<b>Napa Auto Parts- Town</b>					
11/20/2017	853293,8541...	Oil Filter, Fuel Filter	303545 · Maint Supplies-Road-HW3	HIGHWAY:Highway-HW3	-91.41
11/20/2017	854580,8549...	Air Filter, Guages	303545 · Maint Supplies-Road-HW3	HIGHWAY:Highway-HW3	-535.18
Total Napa Auto Parts- Town					-626.59
<b>NCPERS Group Life Insurance</b>					
12/13/2017	32586	Life Insurance - HWY Share	100265 · NCPERS Life Ins Payable	HIGHWAY:Highway-HW1	-32.00
Total NCPERS Group Life Insurance					-32.00
<b>Pirtrek</b>					
12/13/2017	S2603246.001		303543 · Maint Supply-Equip-HW3	HIGHWAY:Highway-HW3	-39.99
Total Pirtrek					-39.99
<b>Ready Refresh by Nestle</b>					
12/13/2017	17K8105519...	Bottled Water	303549 · Operating Supplies-HW3	HIGHWAY:Highway-HW3	-25.22
Total Ready Refresh by Nestle					-25.22
<b>Reichert.Lynn</b>					
12/13/2017	November Cl...	November Cleaning	301543 · Maintenance-HW	HIGHWAY:Highway-HW1	-383.33
12/13/2017	November Cl...	November Cleaning	301543 · Maintenance-HW	HIGHWAY:Highway-HW1	-16.67
12/13/2017	November Cl...	Dental Insurance	303501 · Health Insurance-HW3	HIGHWAY:Highway-HW3	16.67
Total Reichert.Lynn					-383.33
<b>Rod Baker Ford</b>					
12/13/2017	C37407		303522 · Maint Svc-Equip.-HW3	HIGHWAY:Highway-HW3	-1,129.53
Total Rod Baker Ford					-1,129.53
<b>Rush Truck Centers</b>					
12/13/2017	3008658878		303543 · Maint Supply-Equip-HW3	HIGHWAY:Highway-HW3	-261.00
Total Rush Truck Centers					-261.00
<b>RWK Design</b>					
11/20/2017	4107	Monthly Billing for November 2017 - Cloud, 0365, Email -HWY	301543 · Maintenance-HW	HIGHWAY:Highway-HW1	-262.49
11/20/2017	4026	Monthly Billing for October 2017 - Cloud, 0365, Email - HWY	301543 · Maintenance-HW	HIGHWAY:Highway-HW1	-262.49
Total RWK Design					-524.98
<b>Schwab.Ralph</b>					
11/20/2017	11/08/2017	Hydraulic Press	303551 · Small Tools-HW3	HIGHWAY:Highway-HW3	-120.00
Total Schwab.Ralph					-120.00
<b>Smith, Robert</b>					
12/13/2017	December St...	December Storage Rental	303537 · Rentals- Equipment-HW3	HIGHWAY:Highway-HW3	-500.00
Total Smith, Robert					-500.00
<b>Staples Advantage</b>					
11/20/2017	8047165834	Miscellaneous Office Supplies	301578 · Office Supplies-HW	HIGHWAY:Highway-HW1	-269.54
12/13/2017	8047597801	Miscellaneous Office Supplies - HWY Share	301578 · Office Supplies-HW	HIGHWAY:Highway-HW1	-53.47
12/13/2017	8047597801	Miscellaneous Office Supplies - HWY Share	301578 · Office Supplies-HW	HIGHWAY:Highway-HW1	-46.16
Total Staples Advantage					-369.17
<b>Temple Display, LTD</b>					

**Plainfield Township  
Board Audit Report- ROAD AND BRIDGE**

November 9 through December 13, 2017

Date	Num	Memo	Account	Class	Paid Amount
12/13/2017	TDLO27721		303539 · Street Lights-HW3	HIGHWAY:Highway-HW3	-2,450.00
Total Temple Display, LTD					-2,450.00
<b>US Postmaster</b>					
11/20/2017	11/09/2017	Forever Stamps	301530 · Postage-HW	HIGHWAY:Highway-HW1	-49.00
Total US Postmaster					-49.00
<b>Verizon Wireless</b>					
11/20/2017	9795448695	Highway Cell Phones and Ipad	301532 · Telephone/Cell Phones-HW	HIGHWAY:Highway-HW1	-134.07
Total Verizon Wireless					-134.07
<b>West Side Specialized - Use West Side Exc</b>					
12/13/2017	J63026		303543 · Maint Supply-Equip-HW3	HIGHWAY:Highway-HW3	-603.34
Total West Side Specialized - Use West Side Exc					-603.34
<b>Willett Hofmann &amp; Associates Inc.</b>					
12/13/2017	24505	Construction documentation layout and field observation	303533 · Engineering Service-HW3	HIGHWAY:Highway-HW3	-190.95
Total Willett Hofmann & Associates Inc.					-190.95
<b>TOTAL</b>					<b>-22,907.69</b>

**Plainfield Township**  
**Gross HIGHWAY Payroll by Employee by Class**  
 November 9 through December 13, 2017

	Highway-HW1 (HIGHWAY)	Highway-HW3 (HIGHWAY)	HIGHWAY - Other (HIGHWAY)	Total HIGHWAY	TOTAL
Carroll, Melanie J.	3,748.76	0.00	0.00	3,748.76	3,748.76
Cobb, Jimmie R.	0.00	194.10	0.00	194.10	194.10
Conroy, Christian	0.00	1,799.68	0.00	1,799.68	1,799.68
Countryman, Dale W.	0.00	4,701.06	0.00	4,701.06	4,701.06
Illg, Kenneth W.	0.00	4,193.42	0.00	4,193.42	4,193.42
Kujath, Barbara A.	1,644.46	0.00	0.00	1,644.46	1,644.46
Marland, Benjamin J.	0.00	4,803.33	0.00	4,803.33	4,803.33
McAllister, Zachary R.	0.00	4,157.26	0.00	4,157.26	4,157.26
Richter, Michael D	0.00	2,489.76	0.00	2,489.76	2,489.76
Schwab, Ralph L.	0.00	5,712.66	0.00	5,712.66	5,712.66
Young, George R	0.00	1,244.88	0.00	1,244.88	1,244.88
No name	0.00	-25.37	-5,843.73	-5,869.10	-5,869.10
<b>TOTAL</b>	<b>5,393.22</b>	<b>29,270.78</b>	<b>-5,843.73</b>	<b>28,820.27</b>	<b>28,820.27</b>



Town Fund Monthly Budget Report

Acct. #	17-18 Budget	Apr-17	May-17	Jun-17	Jul-17	17-Aug	17-Sep	17-Oct	Nov-17	Dec 1st - Dec 13th	Jan-18	Feb-18	Mar-18	Trans Out	Trans In	Bal. To Date	% to Bgdt	Monies Unspent	
<b>ASSESSOR</b>																			
102500 Salaries (Gross)	\$ 200,000	\$ 13,866.00	\$ 15,147.00	\$ 21,292.25	\$ 13,069.00	\$ 12,797.00	\$ 12,052.00	\$ 14,482.63	\$ 12,043.00	\$ 6,415.25	\$ -	\$ -	\$ -	\$ -	\$ -	\$ 121,164.13	61%	78,835.87	
102508 Social Security	\$ 16,000	\$ 1,054.39	\$ 1,152.17	\$ -	\$ -	\$ -	\$ -	\$ -	\$ -	\$ -	\$ -	\$ -	\$ -	\$ -	\$ -	\$ 2,206.56	14%	13,793.44	
102510 IMRF	\$ 28,000	\$ 1,023.40	\$ 1,380.41	\$ 2,179.27	\$ 1,406.76	\$ 1,093.06	\$ 1,033.40	\$ 1,173.89	\$ 1,917.70	\$ 551.39	\$ -	\$ -	\$ -	\$ -	\$ -	\$ 11,759.28	42%	16,240.72	
<b>Total Ass't Salaries</b>	\$ 244,000	\$ 15,944	\$ 17,680	\$ 23,472	\$ 14,476	\$ 13,890	\$ 13,085	\$ 15,657	\$ 13,961	\$ 6,967	\$ -	\$ -	\$ -	\$ 0	\$ 0	\$ 135,129.97	55%	108,870.03	
102520 Main. Serv. - Equip.	\$ 1,200	\$ 156.15	\$ 114.06	\$ 48.28	\$ 60.00	\$ 191.13	\$ 103.48	\$ 60.00	\$ 79.66	\$ -	\$ -	\$ -	\$ -	\$ -	\$ -	\$ 812.76	68%	387.24	
102530 Postage	\$ 3,300	\$ -	\$ -	\$ -	\$ -	\$ -	\$ -	\$ -	\$ -	\$ -	\$ -	\$ -	\$ -	\$ -	\$ -	\$ 3,300.00	0%	0.00	
102534 Publishing	\$ 100	\$ -	\$ -	\$ -	\$ -	\$ -	\$ -	\$ -	\$ -	\$ -	\$ -	\$ -	\$ -	\$ -	\$ -	\$ -	0%	100.00	
102536 Printing	\$ 1,500	\$ -	\$ -	\$ -	\$ -	\$ -	\$ -	\$ -	\$ -	\$ -	\$ -	\$ -	\$ -	\$ -	\$ -	\$ -	0%	1,500.00	
102538 Dues	\$ 100	\$ -	\$ -	\$ -	\$ -	\$ -	\$ -	\$ -	\$ -	\$ -	\$ -	\$ -	\$ -	\$ -	\$ -	\$ -	0%	100.00	
102540 Travel Expenses	\$ 4,000	\$ 300.65	\$ 197.97	\$ 383.89	\$ 308.42	\$ 304.81	\$ 34.26	\$ 26.76	\$ 53.52	\$ -	\$ -	\$ -	\$ -	\$ -	\$ -	\$ 1,610.28	40%	2,389.72	
102542 Training	\$ 6,000	\$ 853.09	\$ 12.18	\$ 370.07	\$ 176.77	\$ 1,015.00	\$ -	\$ -	\$ -	\$ -	\$ -	\$ -	\$ -	\$ -	\$ -	\$ 2,427.11	40%	3,572.89	
102549 Cmpt Consult/Web	\$ 25,000	\$ 259.50	\$ 4,916.22	\$ -	\$ -	\$ 1,233.22	\$ -	\$ -	\$ 524.98	\$ -	\$ -	\$ -	\$ -	\$ -	\$ -	\$ 6,933.92	28%	18,066.08	
102550 Health Insurance	\$ 22,000	\$ 1,104.24	\$ 1,104.24	\$ 1,618.11	\$ 1,098.15	\$ 2,303.94	\$ 1,078.74	\$ 861.00	\$ 643.26	\$ 321.63	\$ -	\$ -	\$ -	\$ -	\$ -	\$ 10,133.31	46%	11,866.69	
102562 Appraisal Fees	\$ 5,000	\$ -	\$ -	\$ -	\$ -	\$ -	\$ -	\$ -	\$ -	\$ -	\$ -	\$ -	\$ -	\$ -	\$ -	\$ 5,000.00	0%	0.00	
102564 Legal Service	\$ 2,000	\$ 146.25	\$ -	\$ -	\$ -	\$ -	\$ -	\$ -	\$ -	\$ -	\$ -	\$ -	\$ -	\$ -	\$ -	\$ 146.25	7%	1,853.75	
102578 Office Supplies	\$ 2,000	\$ -	\$ 157.30	\$ 166.66	\$ -	\$ 92.78	\$ 66.89	\$ -	\$ 133.9	\$ 9.95	\$ -	\$ -	\$ -	\$ -	\$ -	\$ 627.46	31%	1,372.54	
102585 Software/Licenses	\$ 45,000	\$ 42,205.00	\$ -	\$ -	\$ -	\$ -	\$ 1,339.95	\$ 540.00	\$ -	\$ -	\$ -	\$ -	\$ -	\$ -	\$ -	\$ 44,084.95	98%	915.05	
102586 Equipment	\$ 4,000	\$ -	\$ -	\$ -	\$ -	\$ -	\$ -	\$ -	\$ -	\$ -	\$ -	\$ -	\$ -	\$ -	\$ -	\$ -	0%	4,000.00	
102590 Misc. Expense	\$ 500	\$ -	\$ -	\$ -	\$ -	\$ -	\$ -	\$ -	\$ -	\$ -	\$ -	\$ -	\$ -	\$ -	\$ -	\$ -	0%	500.00	
<b>Total Other Exp.</b>	\$ 121,700	\$ 45,025	\$ 6,502	\$ 2,587	\$ 1,643	\$ 5,141	\$ 2,623	\$ 1,488	\$ 1,435	\$ 332	\$ -	\$ -	\$ -	\$ 0	\$ 0	\$ 66,776.04	55%	54,923.96	
<b>TOTAL ASSR.</b>	\$ 365,700	\$ 60,969	\$ 24,182	\$ 26,059	\$ 16,119	\$ 19,031	\$ 15,709	\$ 17,144	\$ 15,396	\$ 7,298	\$ -	\$ -	\$ -	\$ 0	\$ 0	\$ 201,906.01	55%	163,793.99	
<b>CEMETERY</b>																			
103500 Salaries-	\$ 35,875	\$ 2,692.00	\$ 2,692.00	\$ 4,072.00	\$ 2,760.00	\$ 2,760.28	\$ 2,760.00	\$ 2,760.00	\$ 2,759.62	\$ 1,379.81	\$ -	\$ -	\$ -	\$ -	\$ -	\$ 24,635.71	69%	11,239.29	
103502 Extra Labor	\$ 19,000	\$ 1,385.00	\$ 3,388.00	\$ 6,492.00	\$ 3,292.00	\$ 4,186.00	\$ 2,858.00	\$ 1,189.62	\$ 605.75	\$ -	\$ -	\$ -	\$ -	\$ -	\$ -	\$ 23,996.37	123%	(4,396.37)	
103504 Trustees	\$ 1,500	\$ 200.00	\$ -	\$ -	\$ 300.00	\$ -	\$ -	\$ 200.00	\$ -	\$ -	\$ -	\$ -	\$ -	\$ -	\$ -	\$ 700.00	47%	800.00	
103508 Social Security	\$ 5,000	\$ 353.78	\$ 456.84	\$ -	\$ -	\$ -	\$ -	\$ -	\$ -	\$ -	\$ -	\$ -	\$ -	\$ -	\$ -	\$ 810.62	16%	4,189.38	
103510 IMRF	\$ 4,500	\$ 289.42	\$ 289.42	\$ 463.08	\$ 300.28	\$ 297.00	\$ 297.00	\$ 296.66	\$ 571.60	\$ 148.33	\$ -	\$ -	\$ -	\$ -	\$ -	\$ 2,952.79	65%	1,547.21	
<b>Total Cem. Salaries</b>	\$ 65,875	\$ 4,920	\$ 6,826	\$ 11,027	\$ 6,652	\$ 7,243	\$ 5,915	\$ 4,446	\$ 3,837	\$ 1,528	\$ -	\$ -	\$ -	\$ 0	\$ 0	\$ 52,495.49	80%	13,379.51	
103520 Main. Bldg/Equip/Lawn	\$ 18,000	\$ 271.83	\$ 4,196.16	\$ 1,040.52	\$ 1,280.66	\$ 1,809.50	\$ 6,005.00	\$ 498.13	\$ 1,188.14	\$ 213.82	\$ -	\$ -	\$ -	\$ -	\$ -	\$ 16,503.76	92%	1,496.24	
103526 Legal Service	\$ 1,800	\$ -	\$ -	\$ -	\$ -	\$ -	\$ -	\$ -	\$ -	\$ -	\$ -	\$ -	\$ -	\$ -	\$ -	\$ -	0%	1,800.00	
103532 Telephone	\$ 1,000	\$ -	\$ 164.40	\$ 93.52	\$ 105.33	\$ 91.22	\$ 91.00	\$ 91.72	\$ 147.04	\$ -	\$ -	\$ -	\$ -	\$ -	\$ -	\$ 784.23	78%	215.77	
103544 Utilities-Elec/Gas/Water	\$ 3,600	\$ 99.58	\$ 99.61	\$ 132.50	\$ 137.29	\$ 222.07	\$ 255.00	\$ -	\$ 175.0	\$ -	\$ -	\$ -	\$ -	\$ -	\$ -	\$ 1,121.02	75%	378.98	
103547 Insurance	\$ 3,000	\$ 3,600.00	\$ -	\$ -	\$ -	\$ -	\$ -	\$ -	\$ -	\$ -	\$ -	\$ -	\$ -	\$ -	\$ -	\$ 3,600.00	100%	0.00	
103552 Health Insurance	\$ 12,000	\$ 1,051.34	\$ 630.95	\$ 929.19	\$ 639.52	\$ 1,515.68	\$ 619.00	\$ 619.46	\$ 619.46	\$ 309.73	\$ -	\$ -	\$ -	\$ -	\$ -	\$ 6,934.33	58%	5,065.67	
103578 Office/Operating Supply	\$ 3,500	\$ 55.00	\$ 39.29	\$ -	\$ -	\$ 752.07	\$ -	\$ -	\$ 45.18	\$ -	\$ -	\$ -	\$ -	\$ -	\$ -	\$ 891.54	25%	2,608.46	
103580 Fuel	\$ 2,900	\$ 115.49	\$ 411.00	\$ 374.55	\$ 244.00	\$ 591.25	\$ 331.46	\$ -	\$ -	\$ -	\$ -	\$ -	\$ -	\$ -	\$ -	\$ 2,067.75	71%	832.25	
103584 Concrete/Foundations	\$ 8,500	\$ -	\$ 642.00	\$ 3,111.95	\$ 1,507.44	\$ 3,367.00	\$ -	\$ -	\$ 1,626.50	\$ 548.50	\$ -	\$ -	\$ -	\$ -	\$ -	\$ 10,803.39	127%	(2,303.39)	
103586 Capital Improv/Equip.	\$ 50,000	\$ 4,000.00	\$ -	\$ -	\$ -	\$ -	\$ -	\$ -	\$ 4,410.00	\$ -	\$ -	\$ -	\$ -	\$ -	\$ -	\$ 11,637.00	23%	38,363.00	
103587 Fence	\$ 20,000	\$ -	\$ -	\$ 5,925.00	\$ -	\$ -	\$ -	\$ 4,410.00	\$ 4,410.00	\$ -	\$ -	\$ -	\$ -	\$ -	\$ -	\$ 18,745.00	94%	1,255.00	
103590 Miscellaneous	\$ 500	\$ -	\$ -	\$ -	\$ -	\$ -	\$ -	\$ -	\$ 44.3	\$ -	\$ -	\$ -	\$ -	\$ -	\$ -	\$ 44.25	9%	455.75	
<b>Total Other Expenses</b>	\$ 123,300	\$ 9,193	\$ 6,183	\$ 11,607	\$ 3,914	\$ 8,349	\$ 7,301	\$ 5,619	\$ 19,893	\$ 1,072	\$ -	\$ -	\$ -	\$ 0	\$ 0	\$ 73,132.27	59%	50,167.73	
<b>Total Cemetery</b>	\$ 189,175	\$ 14,113	\$ 13,010	\$ 22,634	\$ 10,567	\$ 15,592	\$ 13,216	\$ 10,066	\$ 23,830	\$ 2,600	\$ -	\$ -	\$ -	\$ 0	\$ 0	\$ 125,627.76	66%	63,547.24	
<b>Grand Total</b>																\$ 973,046.54		\$ 973,046.54	